

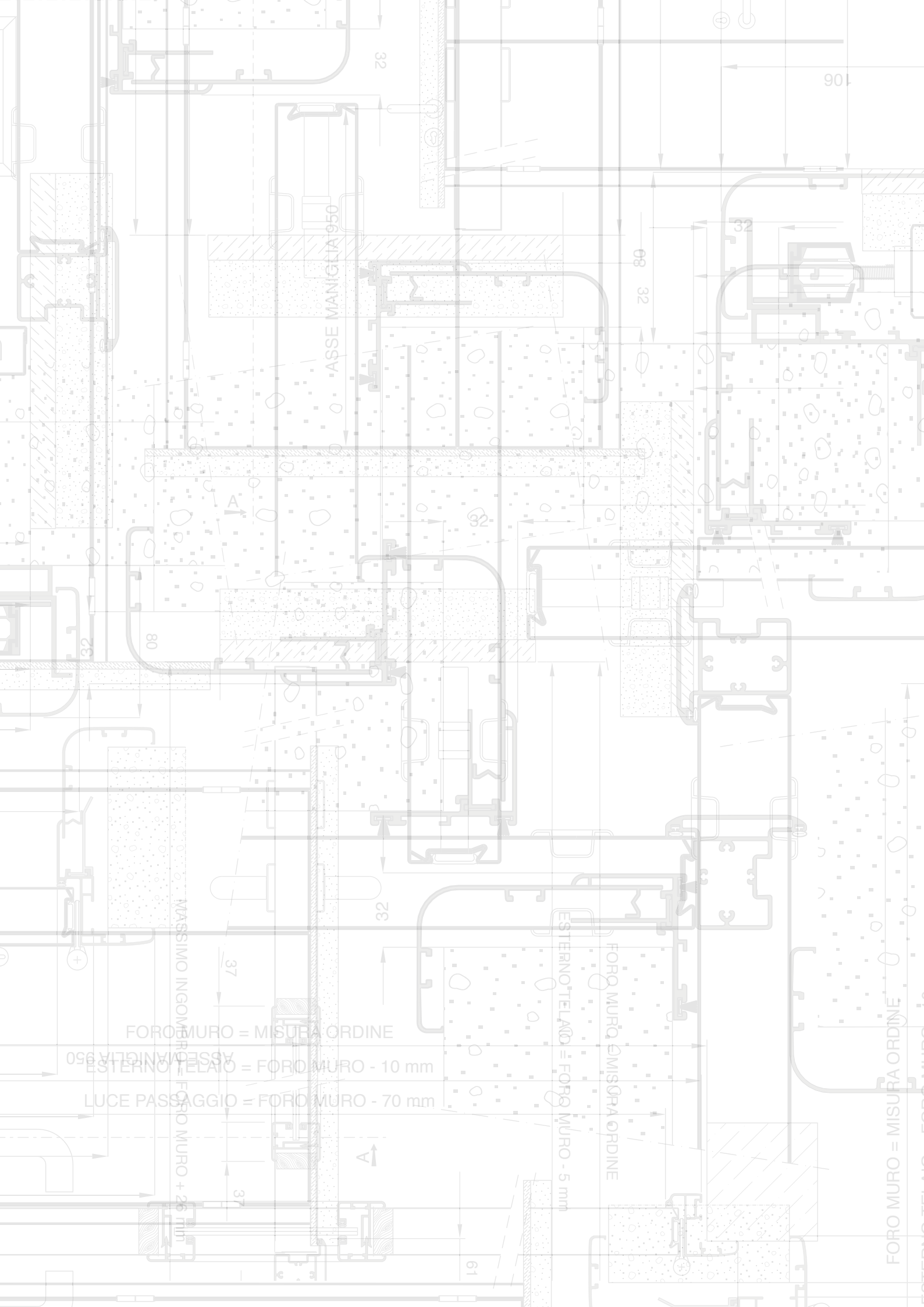

Kora doors for interior

Technical Catalog



KORA doors

Panel options	2
Frame options	4
Opening options	5

KORA

Corner Frame - Embracing Frame

Hinged leaf	6
Swing leaf	12
Standard sizes table	14
Fixing systems	15
Embracing frame system	16
Sliding leaf inside wall	17
Sliding leaf outside wall	19

Reference examples

KORA BASIC

Corner Frame	24
Hinged leaf	

KORA FILL

Embracing frame	25
Hinged leaf	

KORA GLASS

Embracing frame	26
Hinged leaf	

Kora accessories	27
-------------------------	----

Order form	29
-------------------	----

OPENING SYSTEMS:

The opening direction of **Sliding Doors** is determined by looking the door from the frame side (inside view).



The opening direction of **Hinged Doors** is determined by looking the door from the push side.

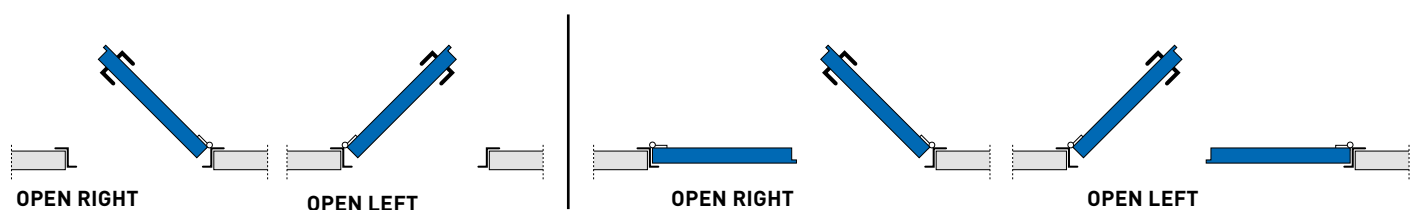

KORA doors

Available products:

KORA BASIC
KORA LAM
KORA FILL
KORA GLASS

Frame options:

CORNER FRAME
EMBRACING FRAME

Opening options:

HINGED
SWING COME&GO
SLIDING OUTSIDE WALL
SLIDING INSIDE WALL



KORA BASIC
steel leaf

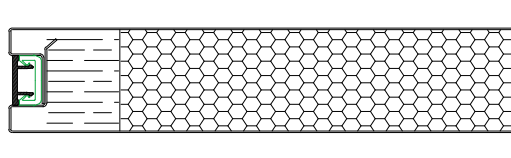

Leaf

Leaf composed by two galvanized steel sheets 6/10 thickness, pre-painted in color RAL 7035 (Goffrato). Sheets covered on the edge by a silver finished galvanized aluminum profile.

Inside insulation in honeycomb paper, hot-glued to the metal sheets giving a single sturdy block.

Accessories

- . Hinges in galvanized steel, silver finished, with teflon self-lubricant bearings and steel support. Easy vertical and horizontal adjustments.
- . Reversible lock with cylinder and three keys.
- . Black handle with rosette.
- . Pre-mounted rubber gasket on the frame perimeter.



KORA LAM
laminated leaf

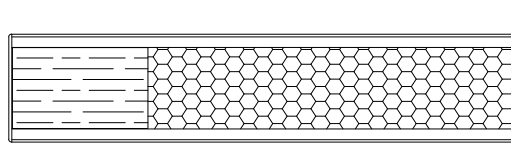

Leaf

Leaf composed by two MDF high density panels (3,2 mm. thickness) with plastic laminate external layers.

Inside insulation in honeycomb paper, glued to the panels.

Wood main structure on the perimeter.

Edges covered by hot-glued PVC slat in silver finish.

Accessories

- . Hinges in galvanized steel, silver finished, with teflon self-lubricant bearings and steel support. Easy vertical and horizontal adjustments.
- . Reversible lock with cylinder and three keys.
- . Black handle with rosette.
- . Pre-mounted rubber gasket on the frame perimeter.

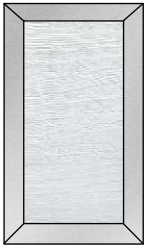

KORA FILL

leaf with edgebanding

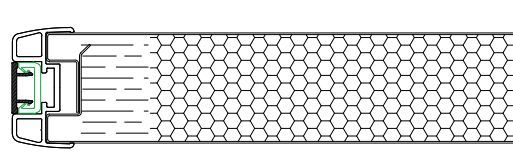

on KORA Lam

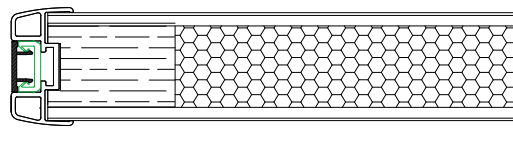

on KORA Basic

Leaf

Leaf composed by two galvanized steel sheets 6/10 thickness, pre-painted in color RAL 7035 (Goffrato) and edged along the perimeter by a 30 mm. deep aluminum profile, silver finished.

Boxed sheets, covered on the edge by a silver finished galvanized aluminum profile.

Inside insulation in honeycomb paper, hot-glued to the metal sheets giving a single sturdy block.

Thanks to its high shock resistance, the structure proves to be suitable for hospital environments. High clearing agents resistance.

Accessories

- . Hinges in galvanized steel, silver finished, with teflon self-lubricant bearings and steel support.
Easy vertical and horizontal adjustments.
- . Reversible lock with cylinder and three keys.
- . Black handle with rosette.
- . Pre-mounted rubber gasket on the frame perimeter.

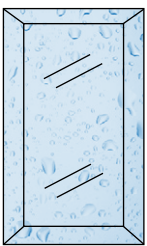

KORA GLASS

glazed leaf

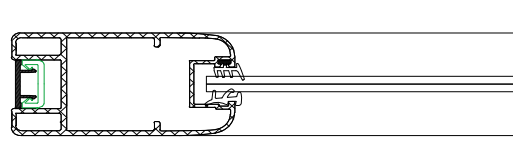

Leaf

Main structure composed of tubular profile in galvanized steel with rounded corners on the perimeter (external sizes mm. 40x157).

Glazing beads not visible.

Safety glass type 3/3.

Available with panic devices and "free / engaged" locks.

Available both single leaf and double leaves (with central "T shaped" joint).

Available in swing opening and external / internal wall sliding versions.

Possibility to match a glazed leaf with a blind leaf (e.g. blind active leaf and glazed secondary leaf). Only full glazed leaf, no horizontal central beam. Main structure in standard silver finish or painted in RAL color.

Accessories

- . Hinges in galvanized steel, silver finished, with teflon self-lubricant bearings and steel support.
Easy vertical and horizontal adjustments.
- . Reversible lock with cylinder and three keys
- . Black handle with rosette.
- . Pre-mounted rubber gasket on the frame perimeter.

Frame options

CORNER FRAME

Anodized aluminum frame, silver finish, cut by 45°. Suitable for fixing by anchor bolts or self-tapping screws.

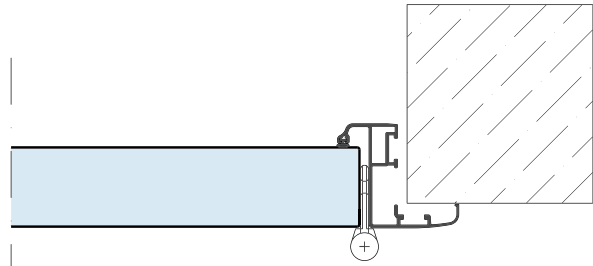

EMBRACING FRAME

Embracing frame system composed by:

- Anodized aluminum frame, silver finish, rounded corners, cut by 45°. Fixing by anchor bolts or self-tapping screws.
- Anodized aluminum covering profile, silver finish, rounded corners, cut by 45°. Available for wall thickness from 100 up to 159 mm.
- Prolonged shaft (on request). It enlarges the covering frame of 60 mm more.

See scheme page 18.

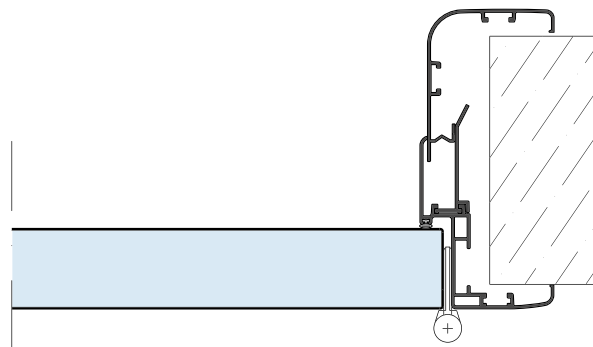

Opening options

HINGED OPENING

Anodized aluminum hinges, silver finish, with self-lubricating nylon bushing and steel pivot. Hinges can be adjusted on two directions. Different leaf height from floor on request.

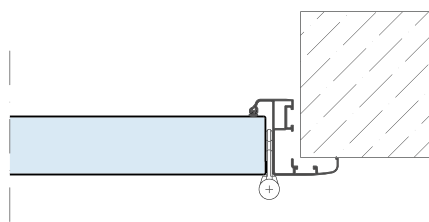

Corner frame

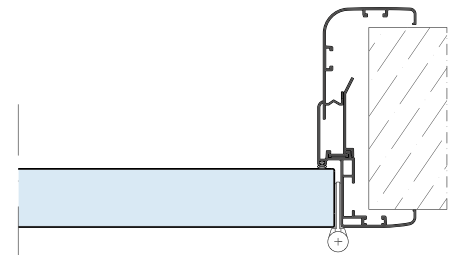

Embracing frame

SWING OPENING

Steel hinges, type Bommer, black painted with "swing" function. Leaf without handle, lock and cylinder. When the door is not moving, the leaf is perfectly aligned with the wall. Different leaf height from floor on request.

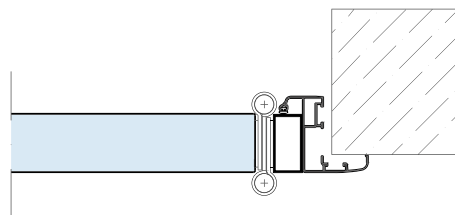

Corner frame

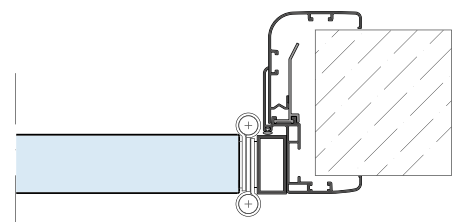

Embracing frame

Opening options

SLIDING OUTSIDE WALL

Extruded aluminum top horizontal single rail allowing the sliding of the runner. Rail covered by rounded section removable housing. Sturdy supporting runner with 4 wheels. Maximum capacity 80 Kg each runner. Covering frame on the door side in profiled aluminum, equipped with protecting brushes and fixings for covering profile. Vertical abutment frame with protecting brushes in case of single leaf door. Hook lock with turning handle, also

available in "Free/ Engaged" version, and counterlock in case of double leaves doors. Recessed handle on both sides. Not available with raised leaf..

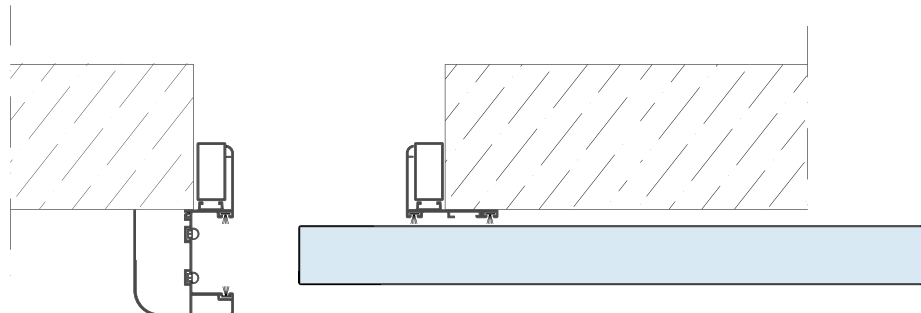

Corner frame

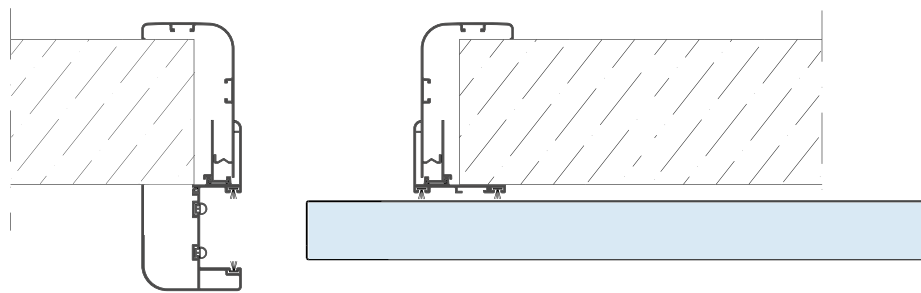

Embracing frame

SLIDING INSIDE WALL

Galvanized steel hidden counterframe. Runner slides along an extrude aluminum block rail composed of one or two lines, with average thickness 2 mm. Sturdy supporting runner with 4 wheels. Maximum capacity 80 Kg each runner. Covering profile in anodized aluminum, with rounded angles, fitted to reach wall thickness from 100 mm up to 145 mm (bigger wall thickness is not available).

Covering profiles are fixed with no visible screws. Hook lock with turning handle, also available in "Free/ Engaged" version, and counterlock in case of double leaves doors. Recessed handle on both sides. Not available with raised leaf.

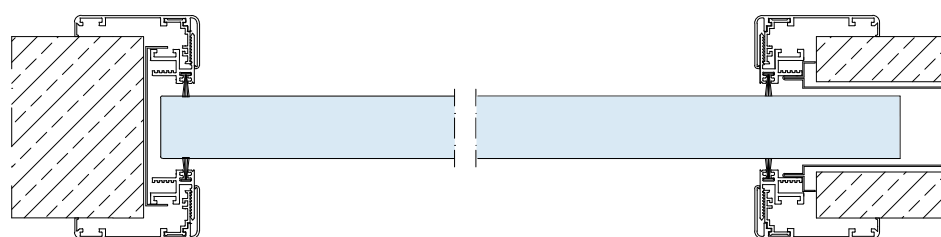

Embracing frame

KORA Corner frame - embracing frame

1 Leaf Door

Section AA embracing frame

Section AA corner frame

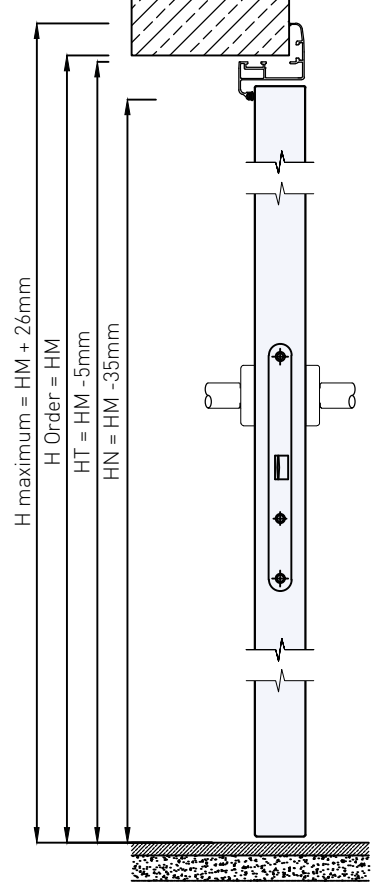
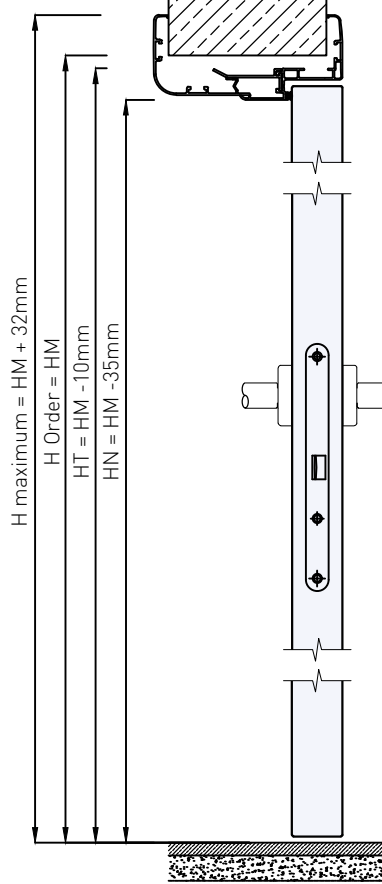
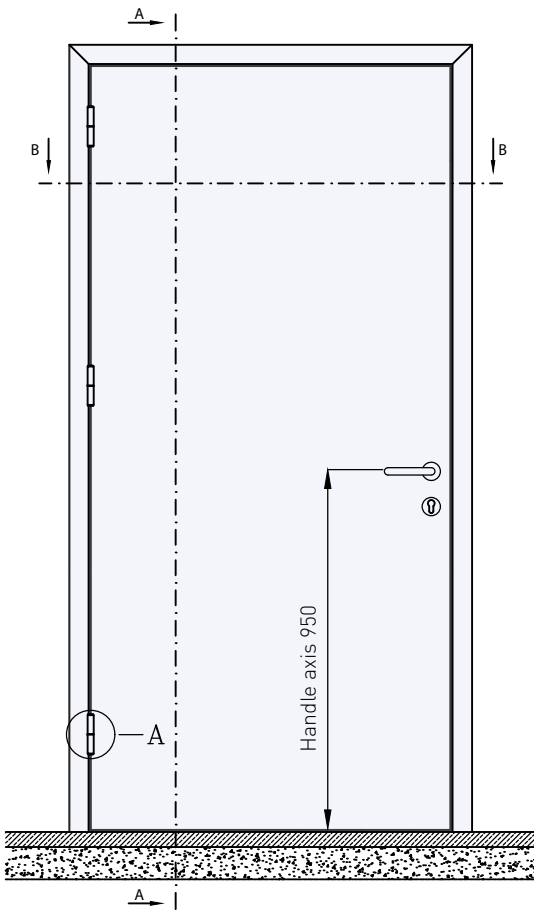

Section BB embracing frame

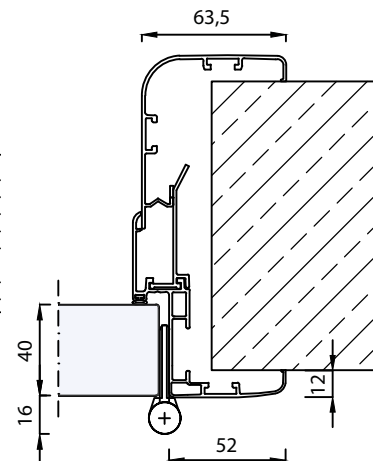
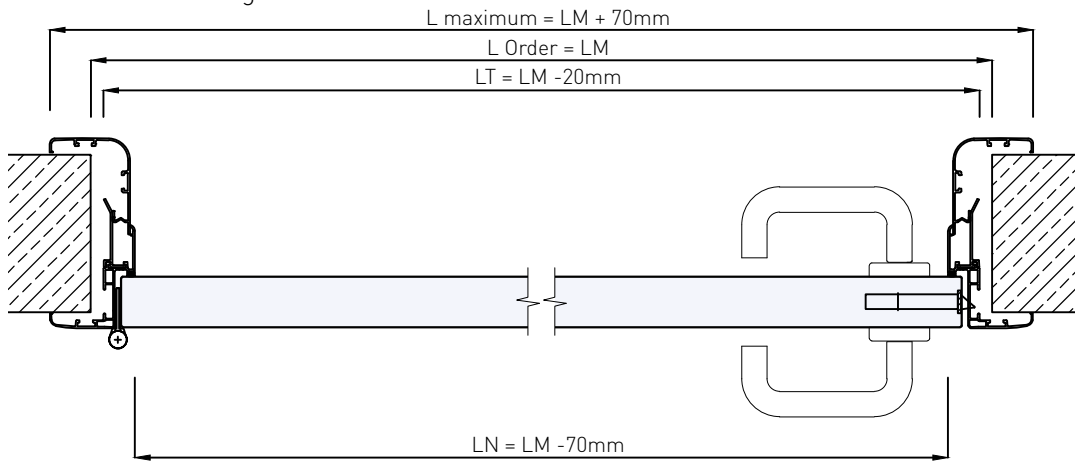

Section BB corner frame

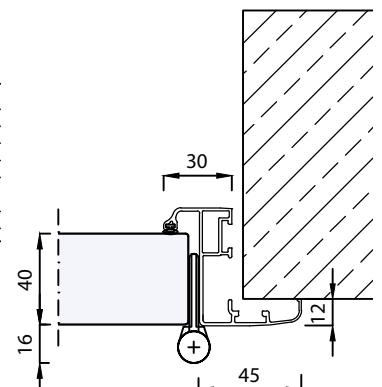
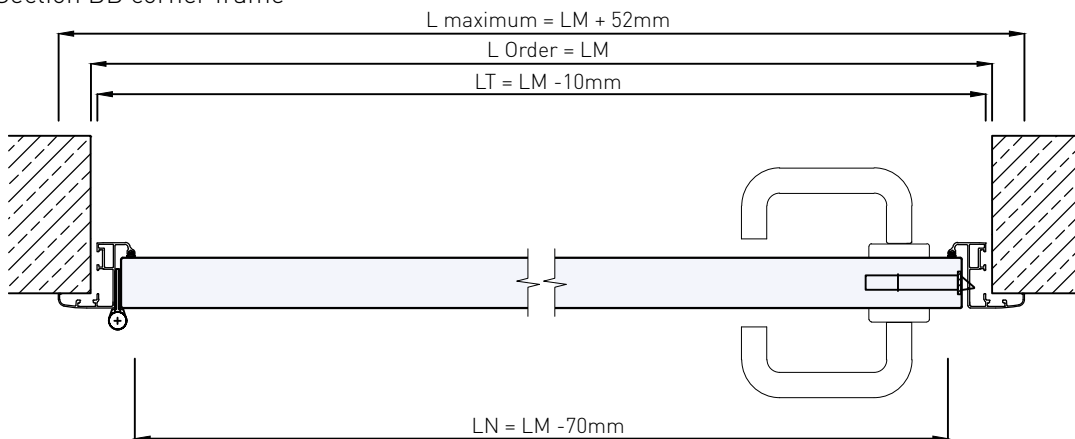

KORA Corner frame - embracing frame

2 Leaves Door

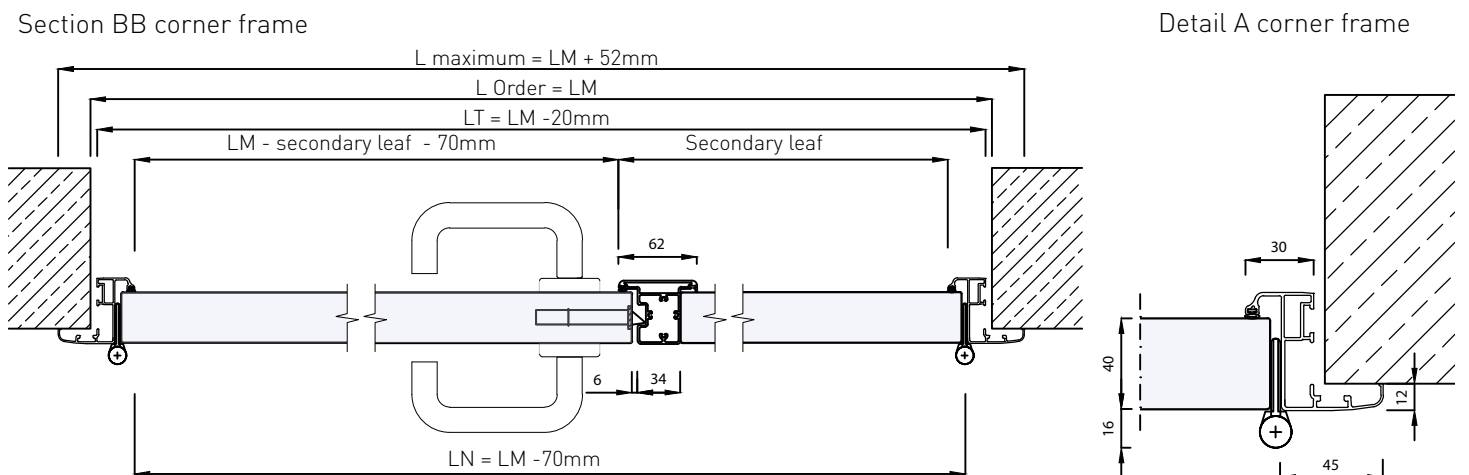
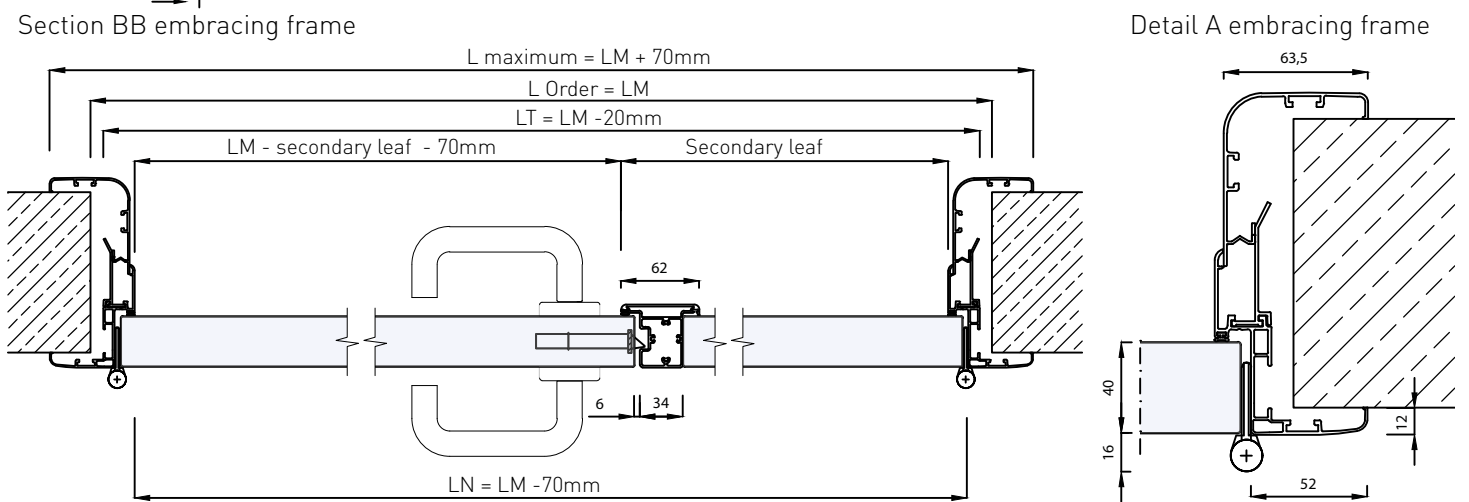
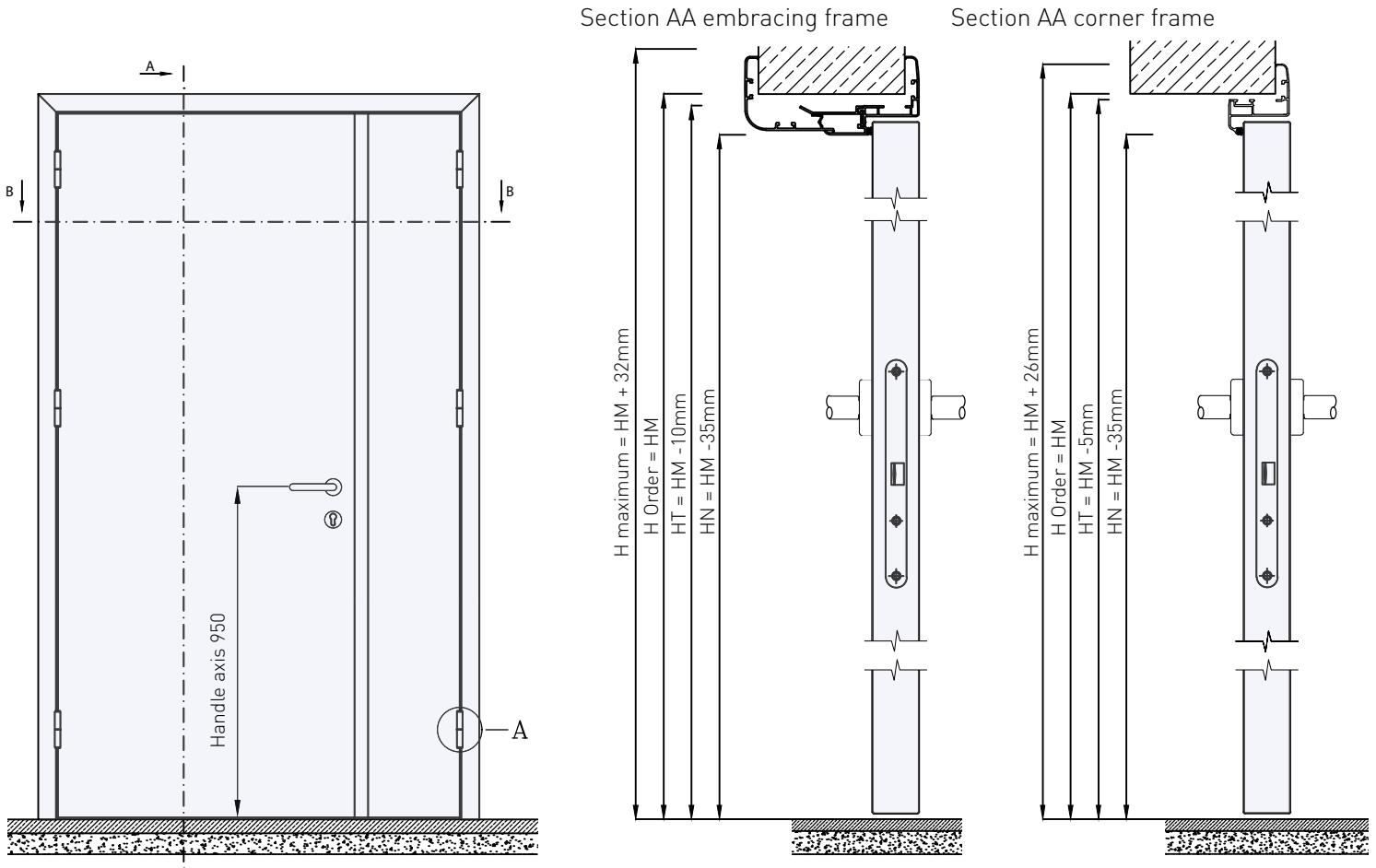

KORA Corner frame - embracing frame

1 Leaf Door with top light and glazed window

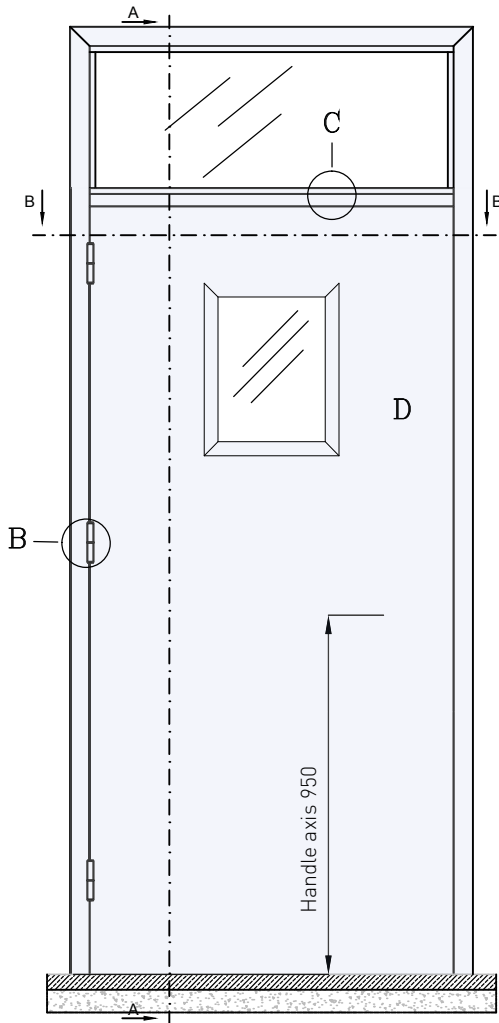

Section AA embracing frame

Section AA corner frame

A

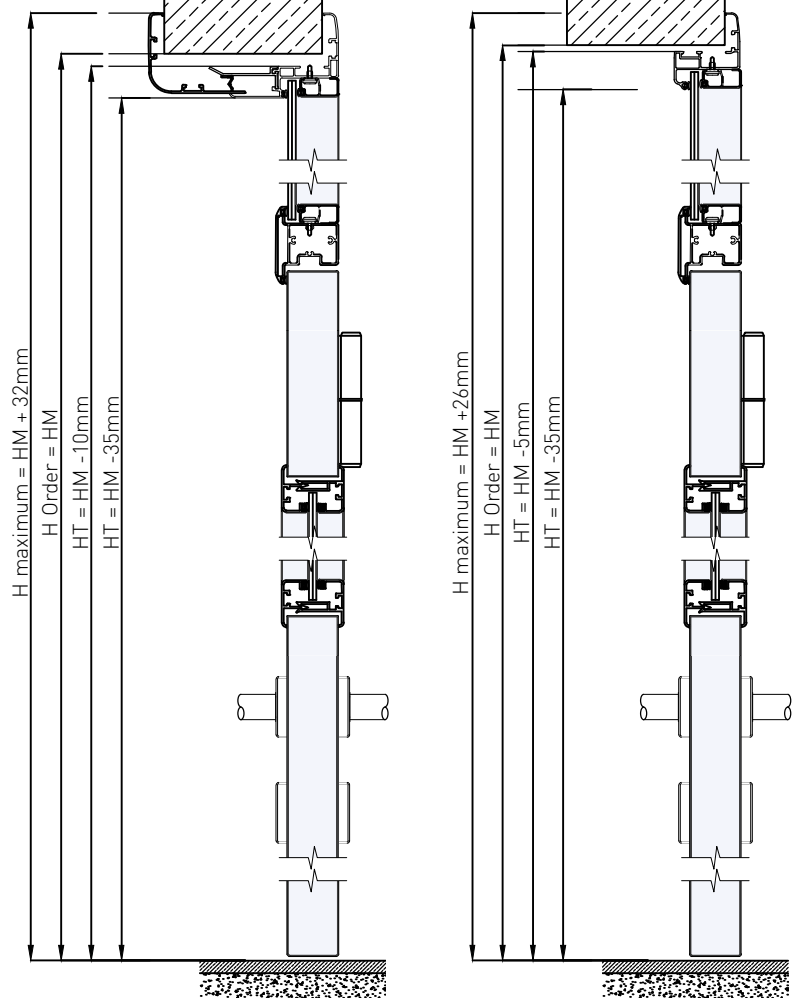

Section BB embracing frame

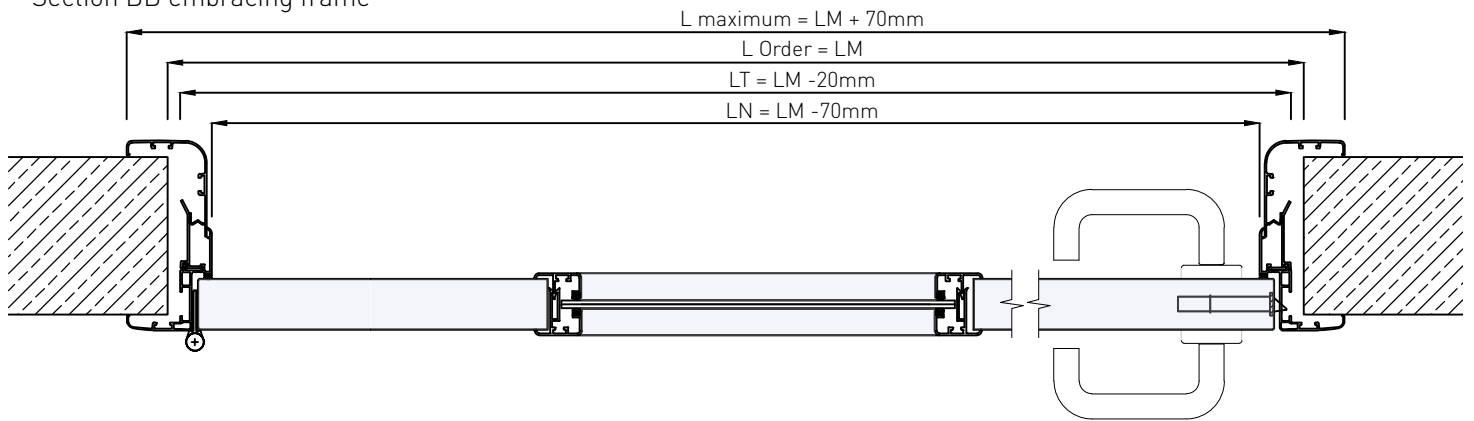

Section BB corner frame

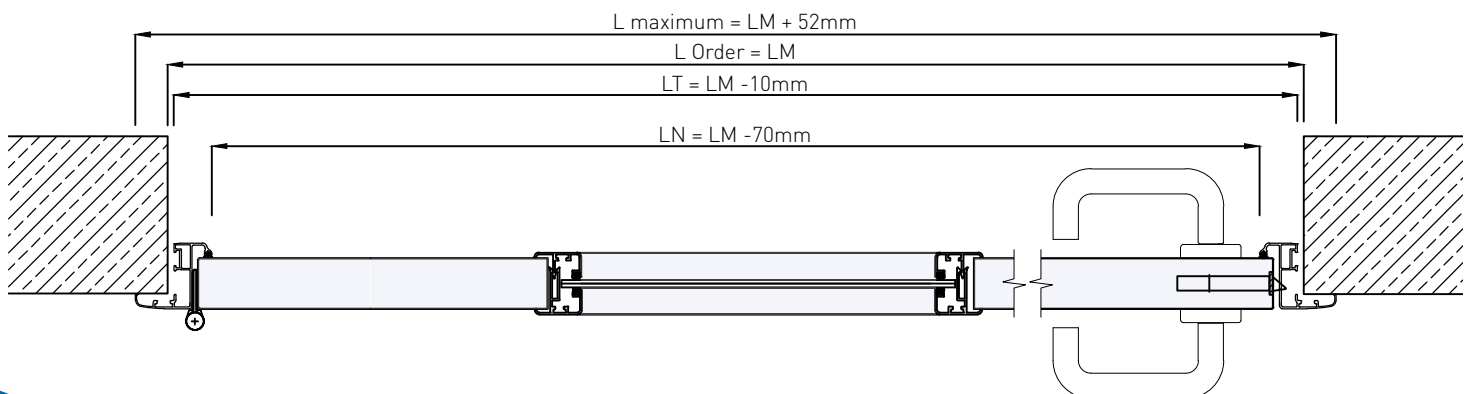

Detail A corner frame

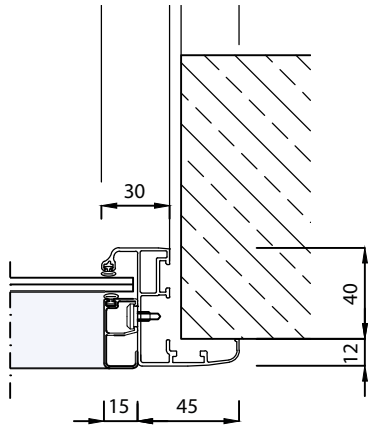

Detail A embracing frame

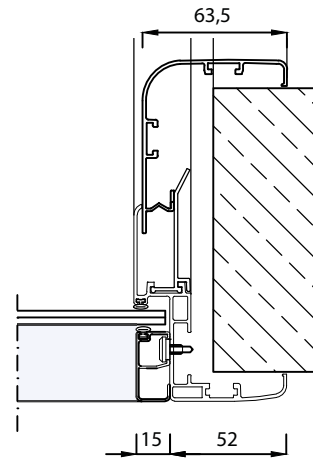

Detail B corner frame

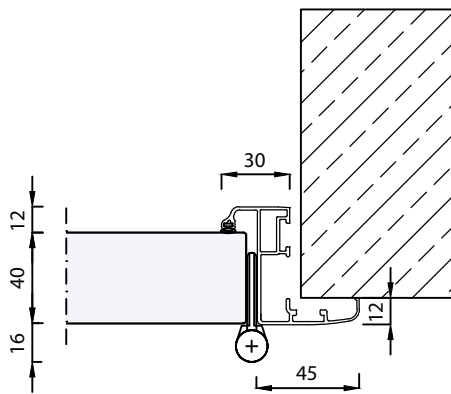

Detail B embracing frame

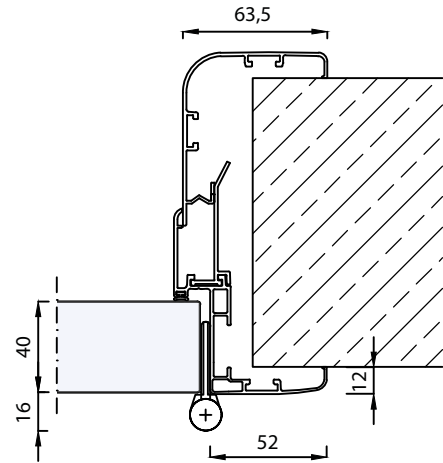

Detail C

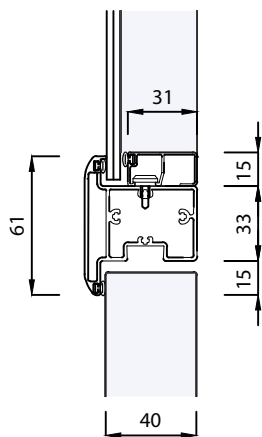

Detail D

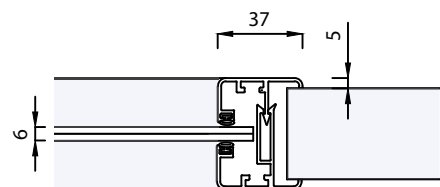

KORA Corner frame - embracing frame

2 Leaves Door with top light and glazed window

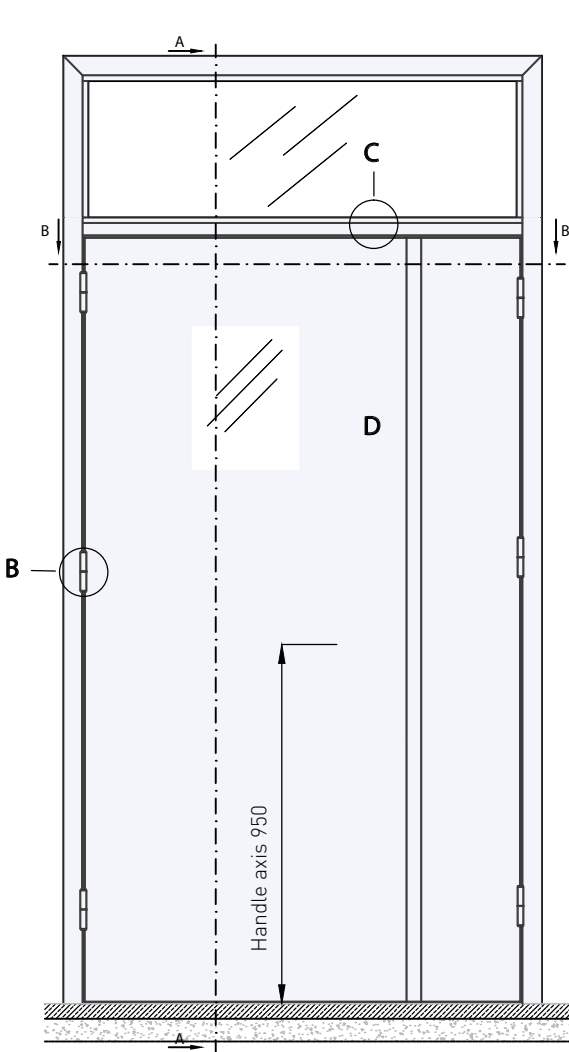

Section AA embracing frame

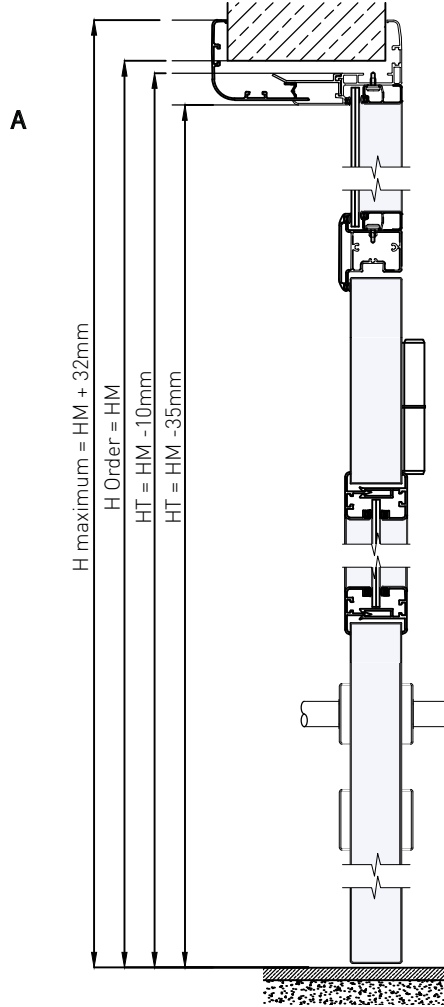

Section AA corner frame

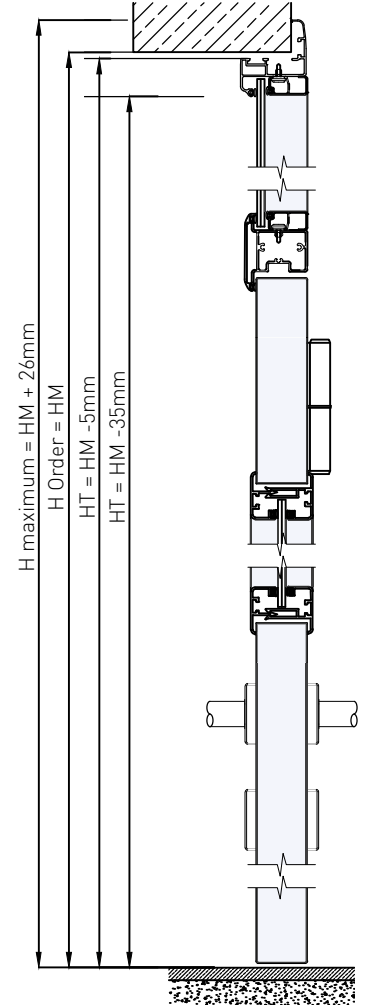

Section BB embracing frame

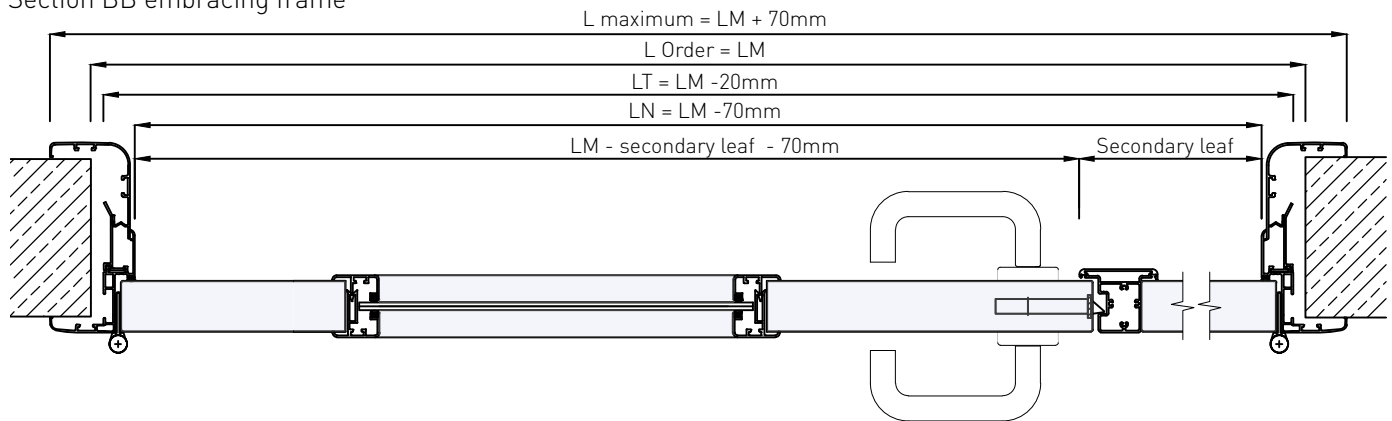

Section BB corner frame

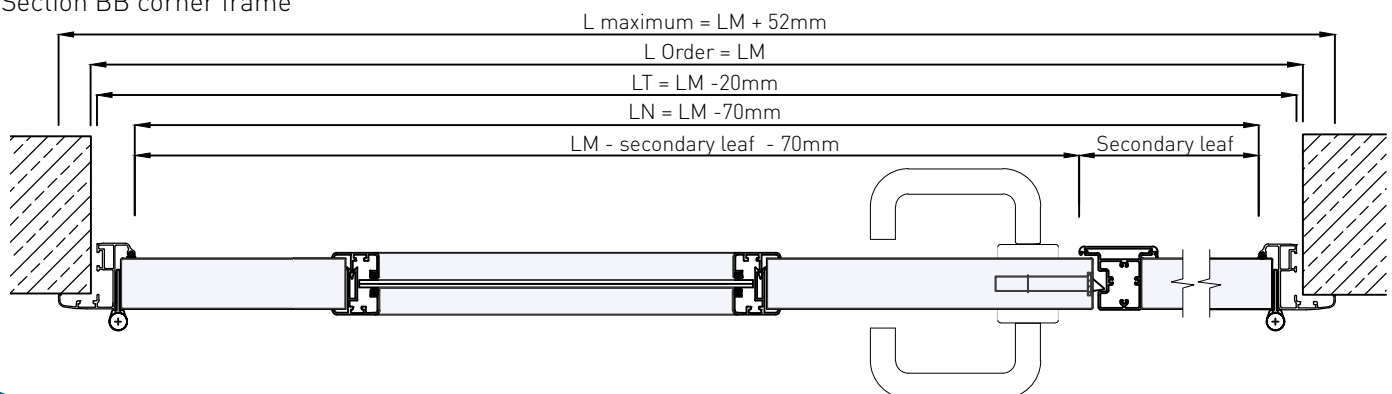

Detail A corner frame

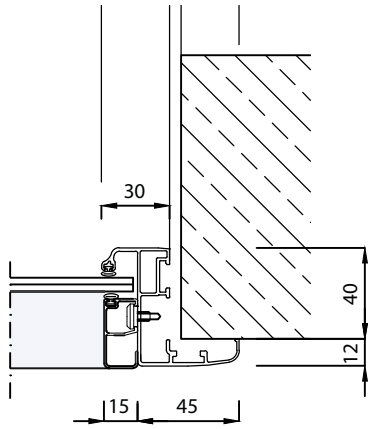

Detail A embracing frame

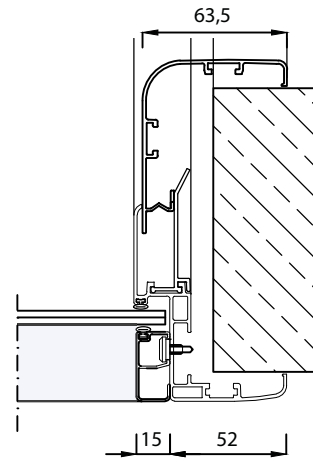

Detail B corner frame

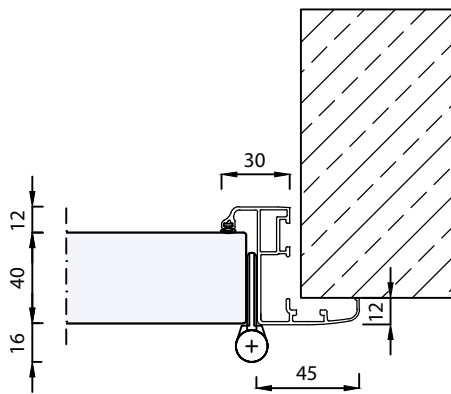

Detail B embracing frame

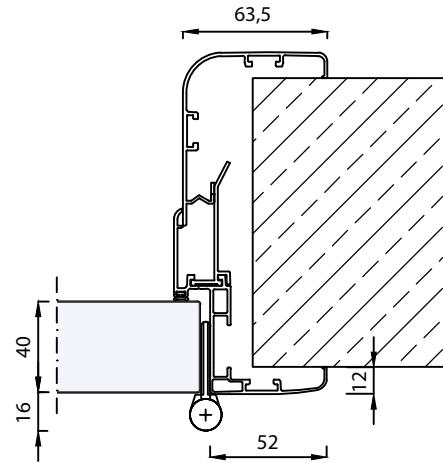

Detail C

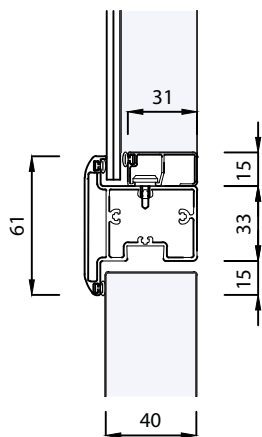

Detail D

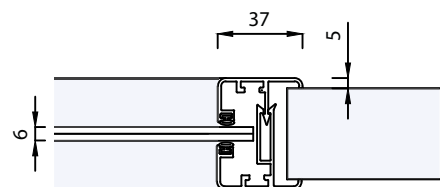

KORA Swing Leaf corner frame - embracing frame

1 Leaf Door

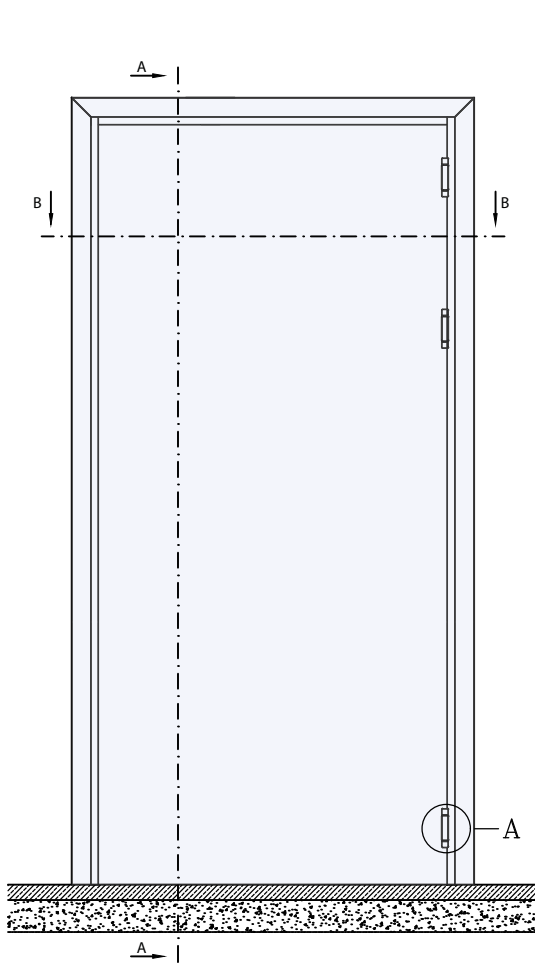

Section BB embracing frame

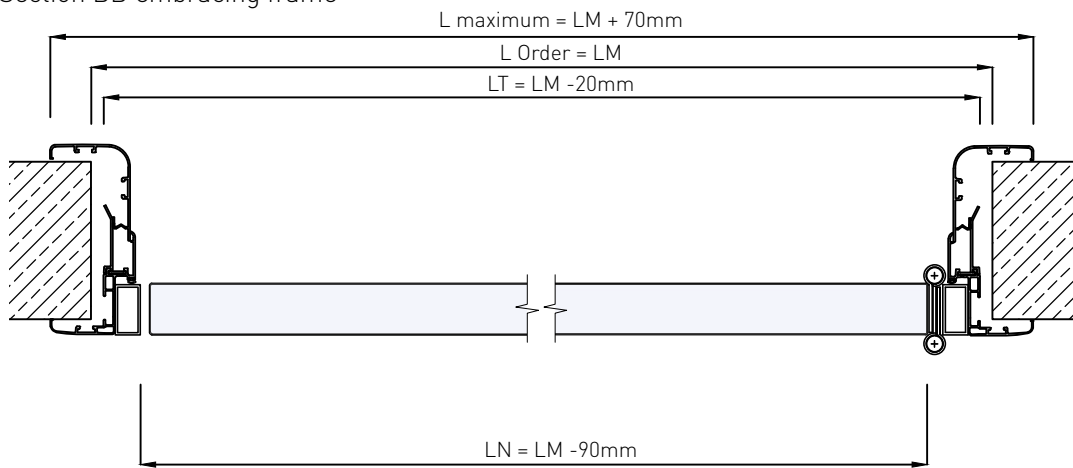

Section BB corner frame

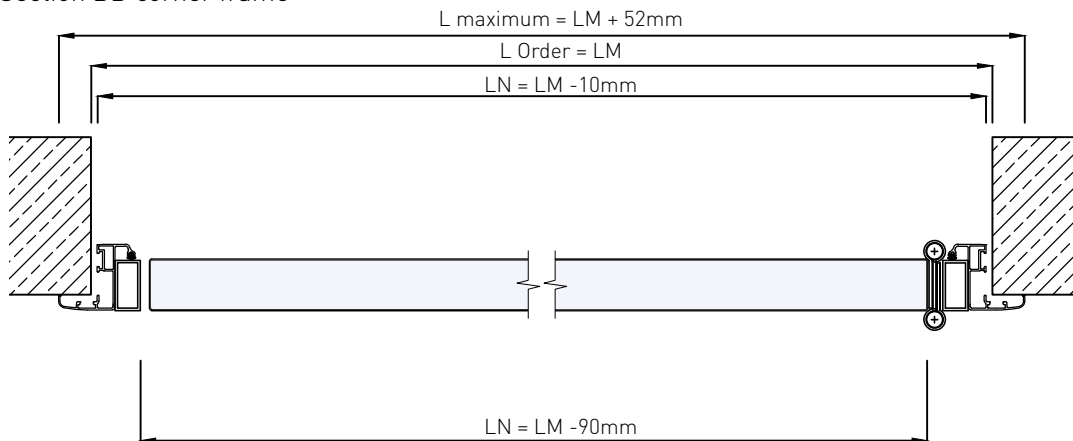

Section AA embracing frame

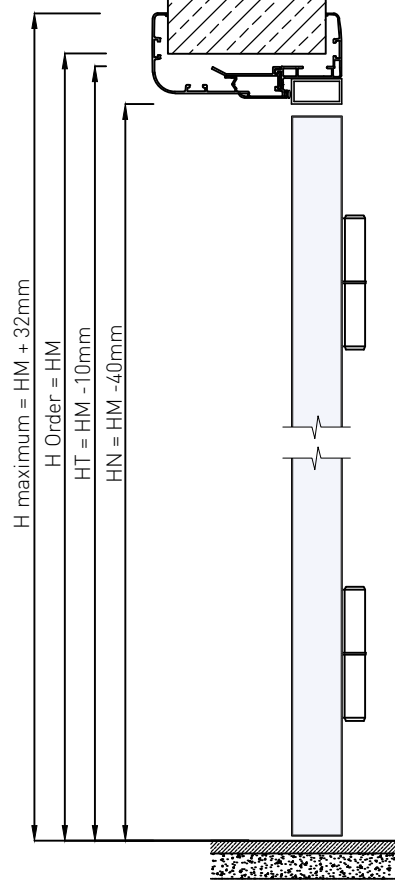

Section AA corner frame

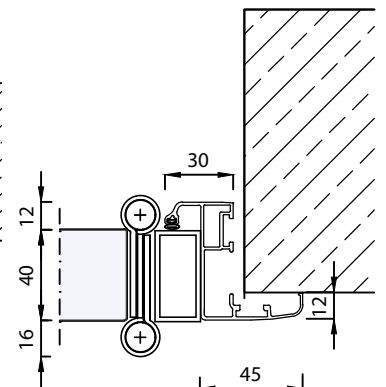
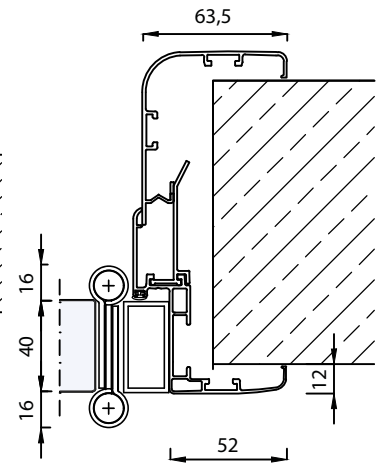
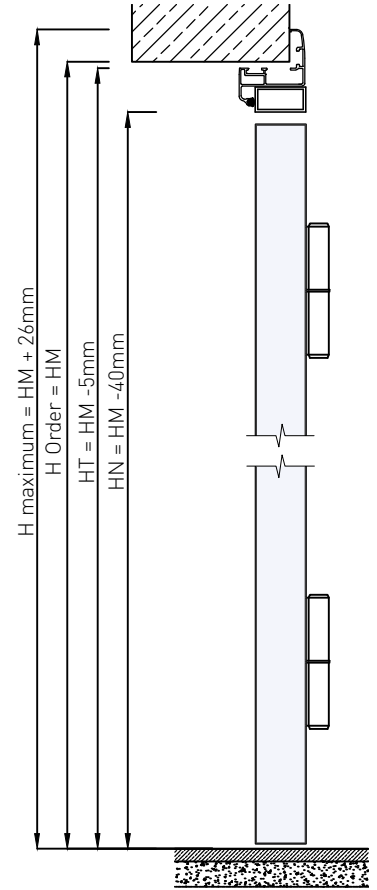

KORA Swing Leaf corner frame - embracing frame

2 Leaves Door

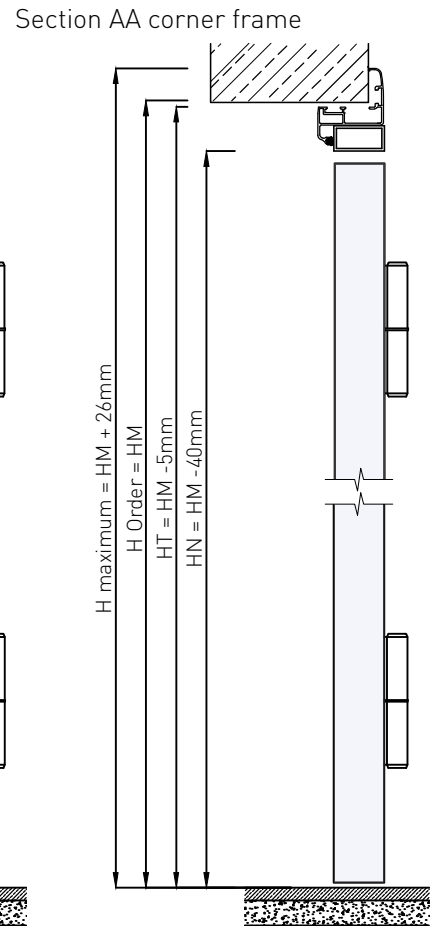
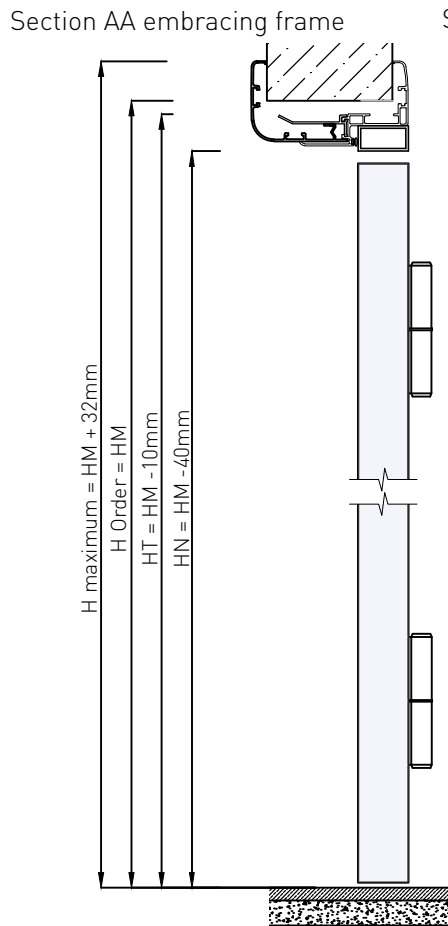
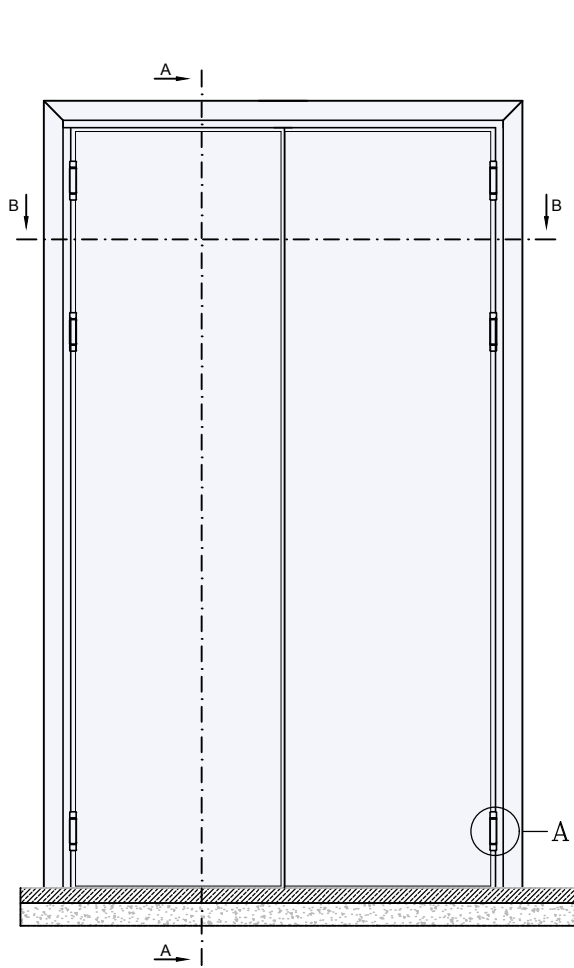

Section BB embracing frame

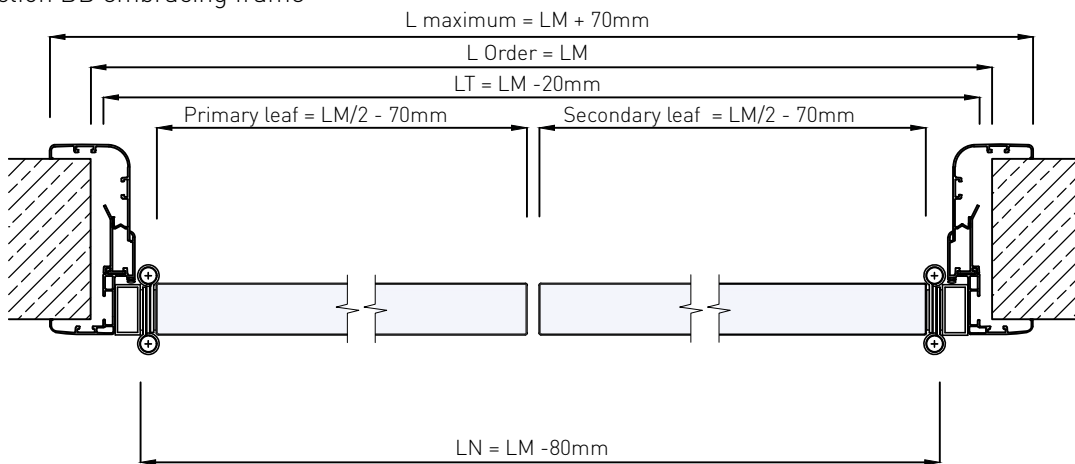

Detail A embracing frame

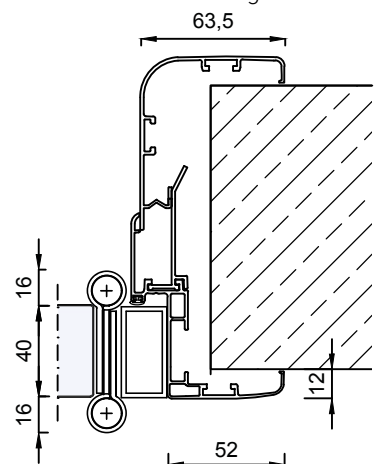

Section BB corner frame

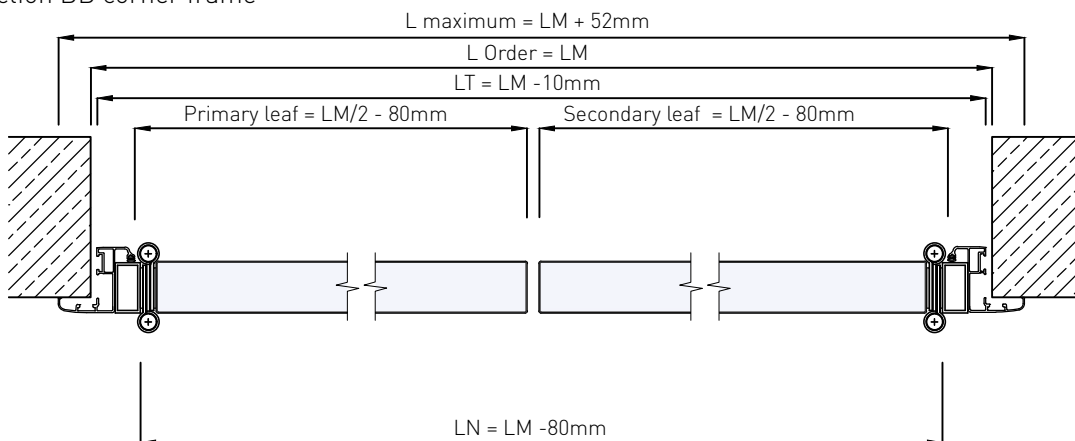

Detail A corner frame

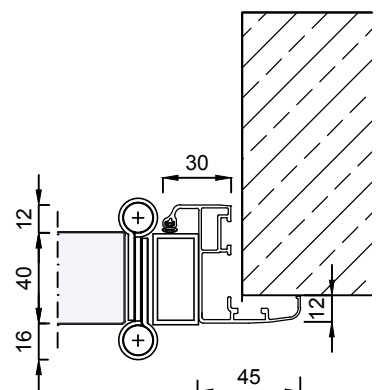

KORA Corner frame - embracing frame

Standard size tables

KORA doors with corner frame and hinged leaf are available in standard sizes

1 Leaf Door

STRUCTURAL WALL SIZE, ORDER SIZE (LMxHM)	EXTERNAL FRAME (LT x HT)	LIGHT PASSAGE (LP x HP)
800 x 2150	790 x 2145	730 x 2115
900 x 2150	890 x 2145	830 x 2115
1000 x 2150	990 x 2145	930 x 2115

2 Leaves Door

STRUCTURAL WALL SIZE, ORDER SIZE (LMxHM)	EXTERNAL FRAME (LT x HT)	LIGHT PASSAGE (LP x HP)
1300 x 2150 (900+400)	1290 x 2145	1240 x 2115
1500 x 2150 (1000+500)	1490 x 2145	1440 x 2115
1700 x 2150 (1000+700)	1690 x 2145	1640 x 2115
1900 x 2150 (1000+900)	1890 x 2145	1840 x 2115

KORA doors with embracing frame and hinged leaf are available in standard sizes

1 Leaf Door

STRUCTURAL WALL SIZE, ORDER SIZE (LMxHM)	EXTERNAL FRAME (LT x HT)	LIGHT PASSAGE (LP x HP)
800 x 2150	780 x 2140	730 x 2115
900 x 2150	880 x 2140	830 x 2115
1000 x 2150	980 x 2140	930 x 2115

2 Leaves Door

STRUCTURAL WALL SIZE, ORDER SIZE (LMxHM)	EXTERNAL FRAME (LT x HT)	LIGHT PASSAGE (LP x HP)
1300 x 2150 (900+400)	1280 x 2140	1230 x 2115
1500 x 2150 (1000+500)	1480 x 2140	1430 x 2115
1700 x 2150 (1000+700)	1680 x 2140	1630 x 2115
1900 x 2150 (1000+900)	1880 x 2140	1830 x 2115

KORA doors with corner frame

Mounting on counter frame

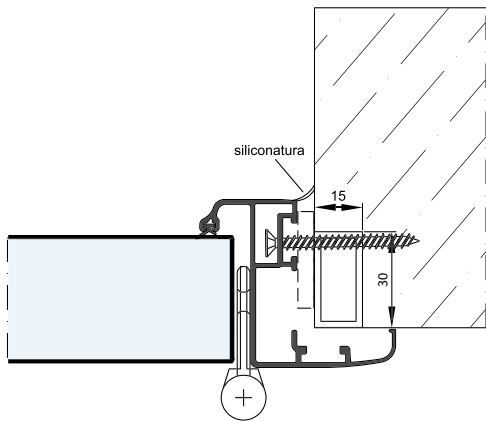

Mounting on concrete wall

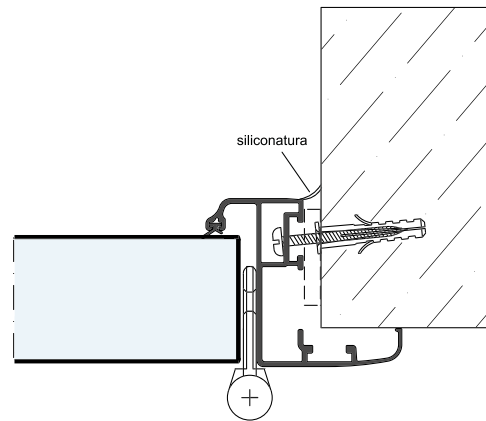

KORA doors with embracing frame

Mounting on gypsum carton

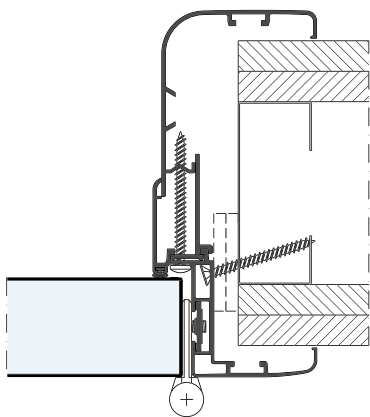

Mounting on wood counter frame

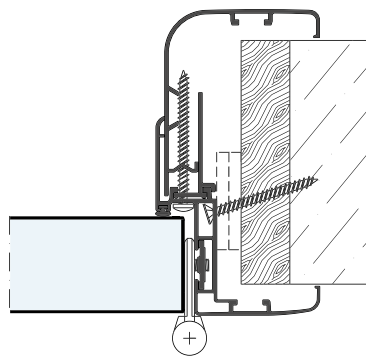

Mounting on concrete wall

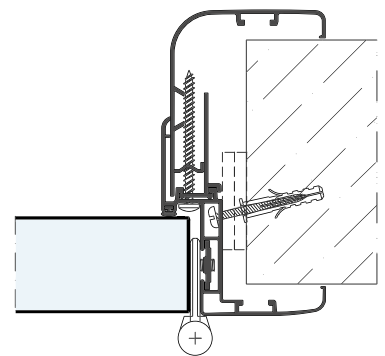

Embracing Frame System for hinged version Kora

Embracing frame system composed by frame + covering profile type A, B + possible extension shaft type P

System type A

SMP min. 100mm max. 129mm

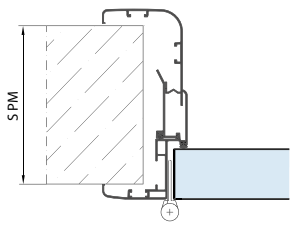

Detail
Covering profile A

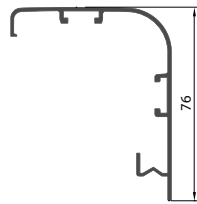

System type A+2P

SMP min. 220mm max. 249mm

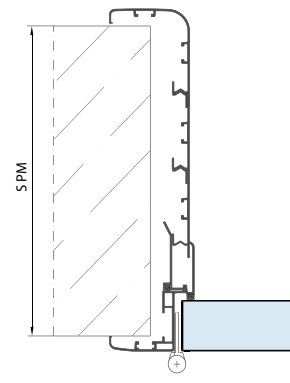

Detail
Covering profile A + 2 shaft P

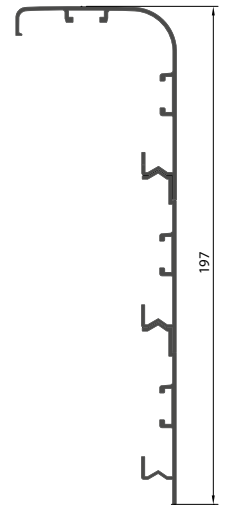

System type B

SMP min. 130mm max. 159mm

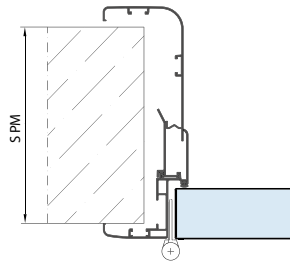

Detail
Covering profile B

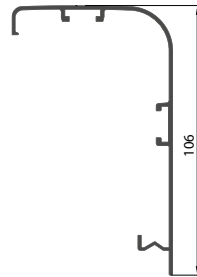

System type B+2P

SMP min. 250mm max. 279mm

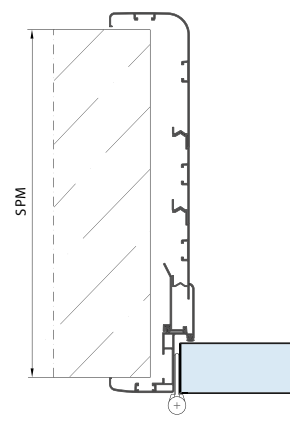

Detail
Covering profile B + 2 shaft P

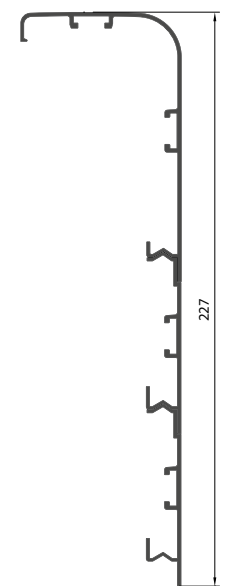

System type A+P

SMP min. 160mm max. 189mm

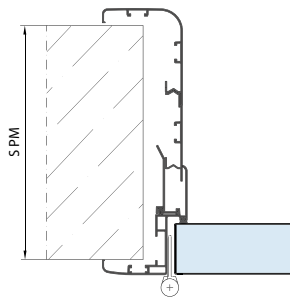

Detail
Covering profile A + 1 shaft P

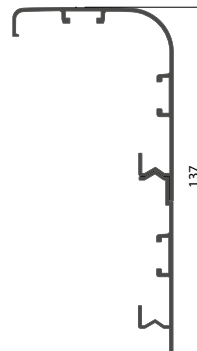

System type B+P

SMP min. 190mm max. 219mm

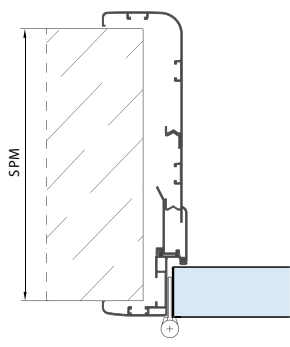

Detail
Covering profile B + 1 shaft P

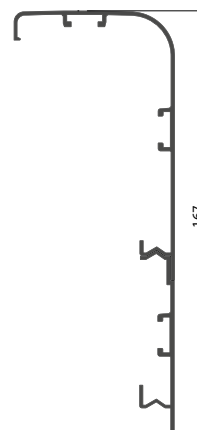

WALL THICKNESS	TYPE	DESCRIPTION
da 100 a 129 mm	A	Covering Profile A
da 130 a 159 mm	B	Covering Profile B
da 160 a 189 mm	A + P	Covering Profile A + 1 shaft P
da 190 a 219 mm	B + P	Covering Profile B + 1 shaft P
da 220 a 249 mm	A + 2P	Covering Profile A + 2 shaft P
da 250 a 279 mm	B + 2B	Covering Profile B + 2 shaft P
Shaft P size always 60 mm Wall thickness SMP to be specified when ordering		

KORA Embracing frame sliding leaf inside wall

1 Leaf Door

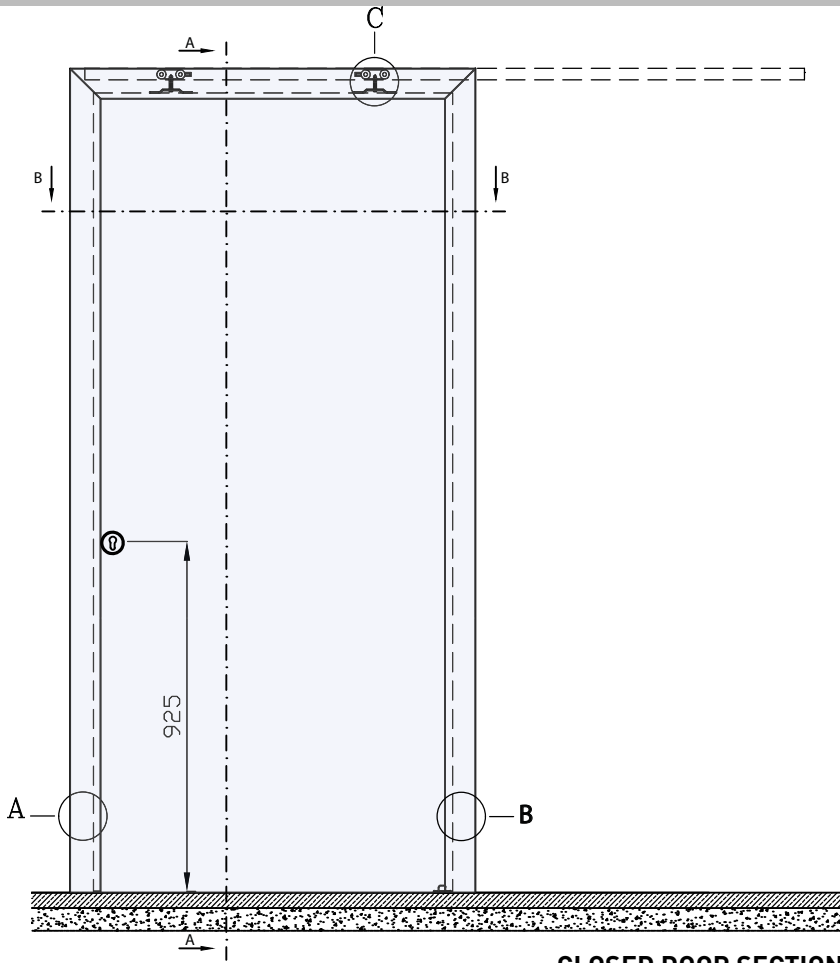

Section AA corner frame

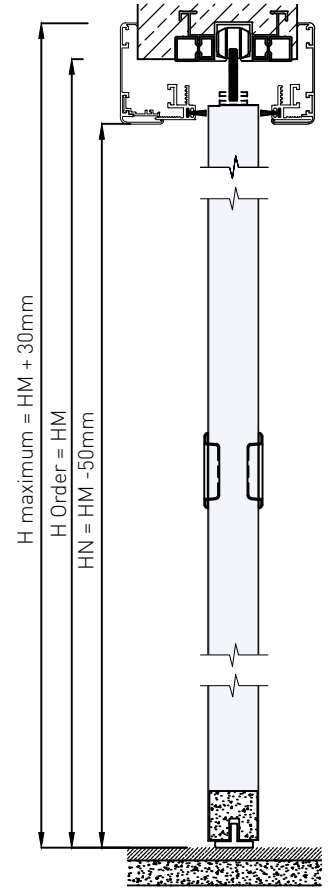

Section BB

CLOSED DOOR SECTION

$L_{\text{maximum}} = LM + 70\text{mm}$

$L_{\text{Order}} = LM$

$LN = LM - 75\text{mm}$

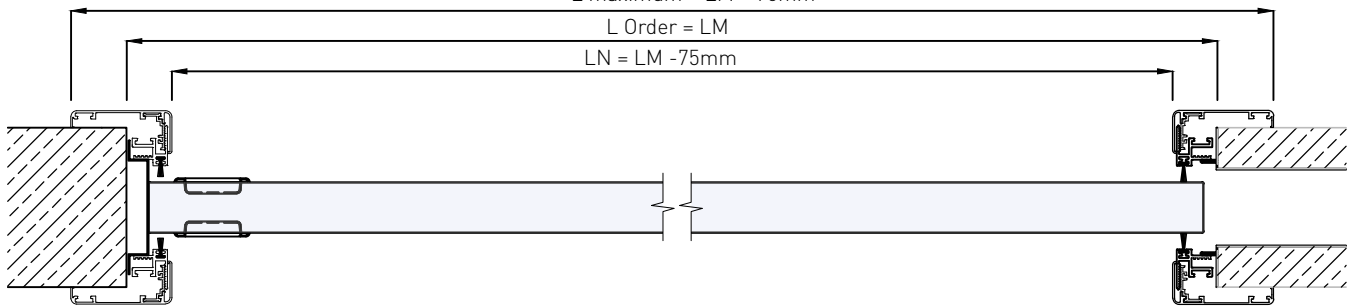

OPENED DOOR SECTION

$LN = LM - 55\text{mm}$

Detail A

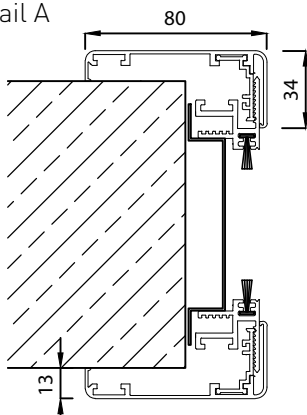

Detail B

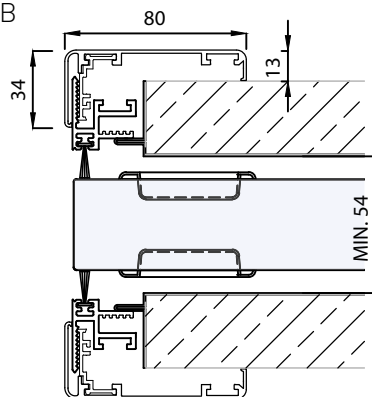

Detail C

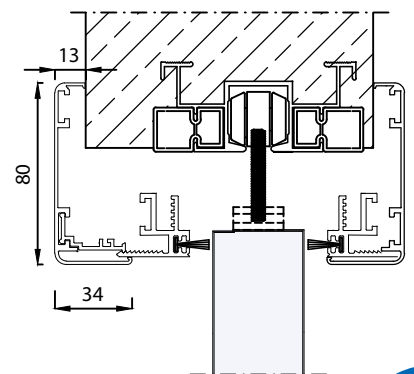

KORA Embracing frame sliding leaf inside wall

2 Leaves Door

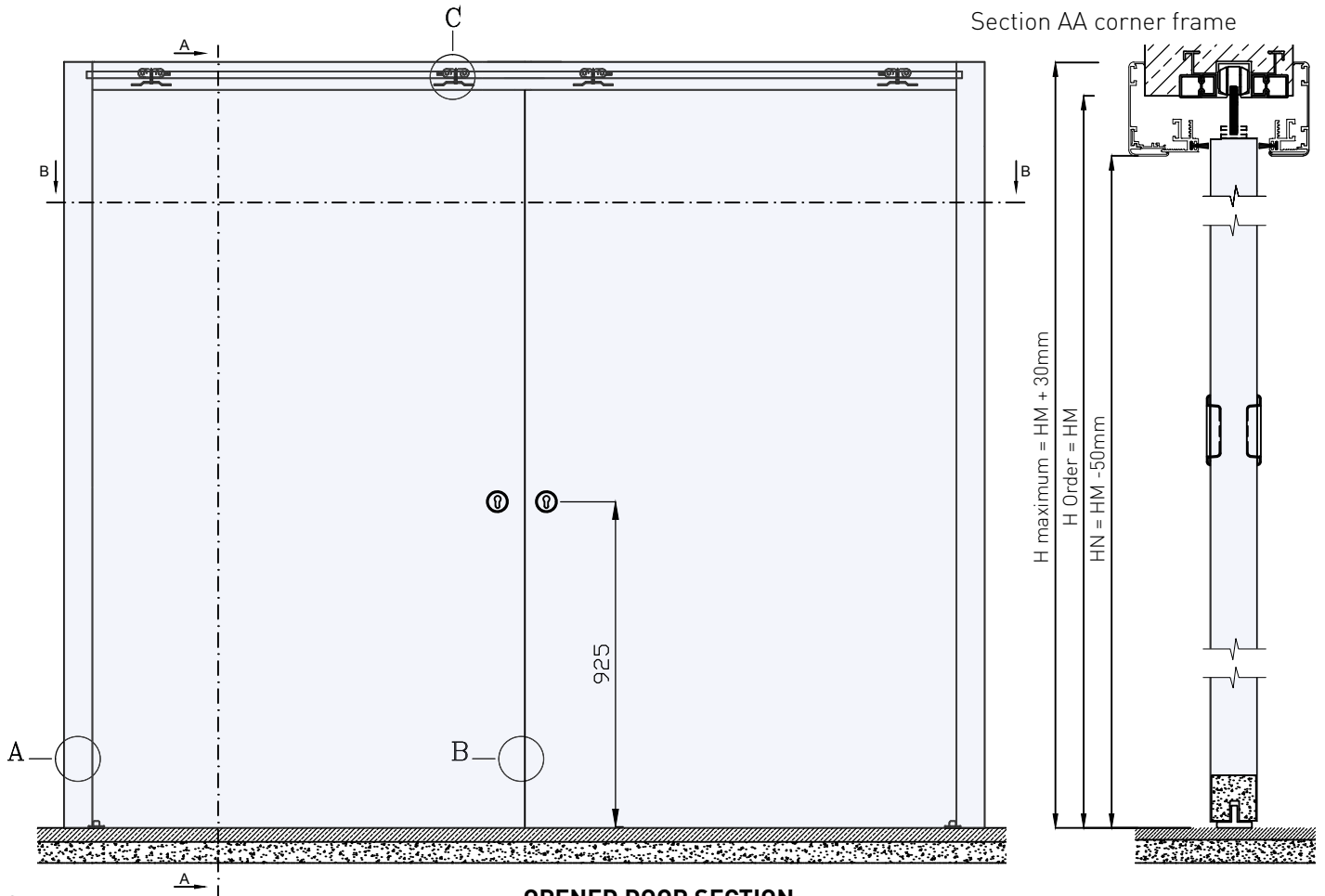

OPENED DOOR SECTION

L maximum = LM + 120mm

L Order = LM

LN = LM - 40mm

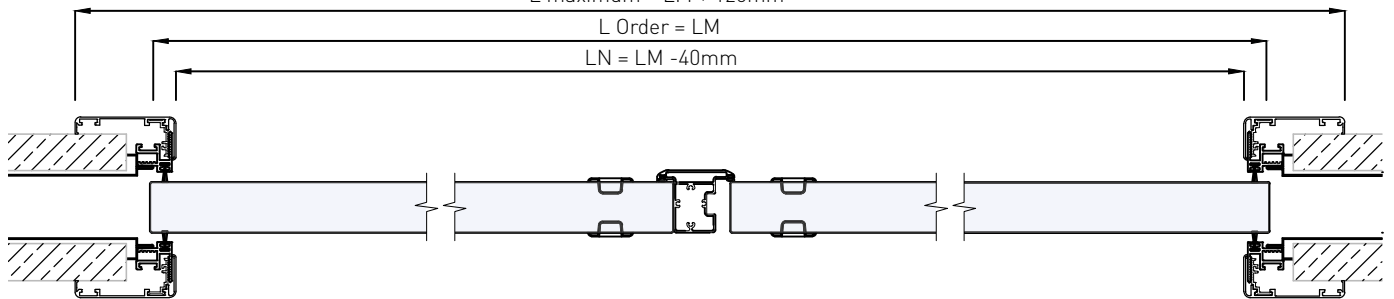

OPENED DOOR SECTION

LN = LM - 105mm

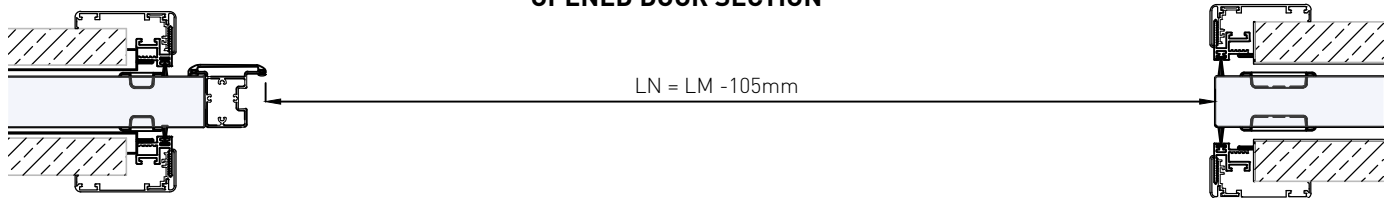

Detail A

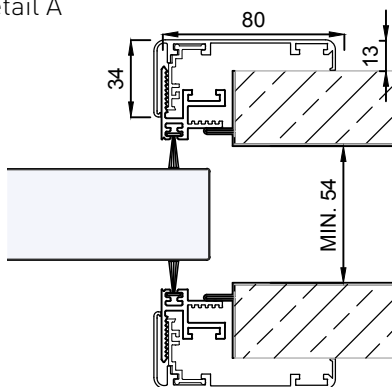

Detail B

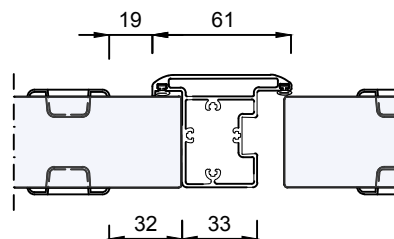

Detail C

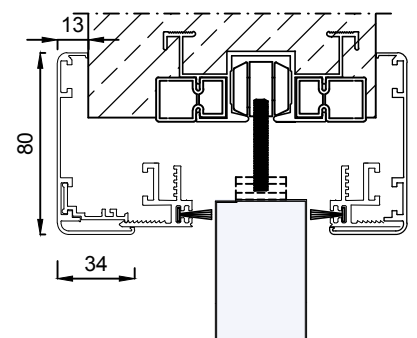

KORA Embracing frame sliding leaf outside wall

1 Leaf Door

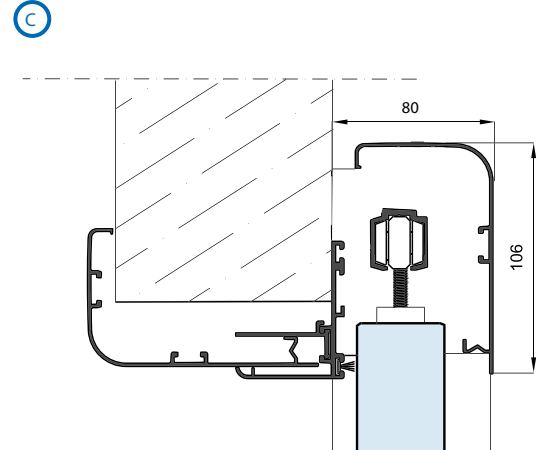
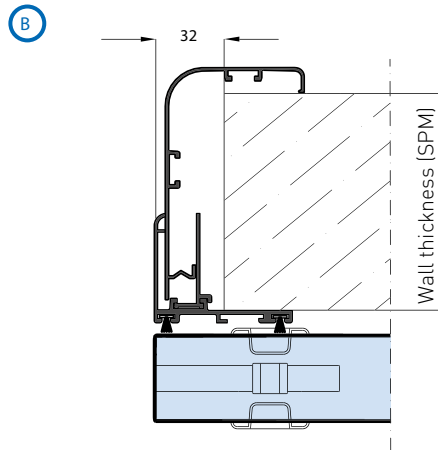
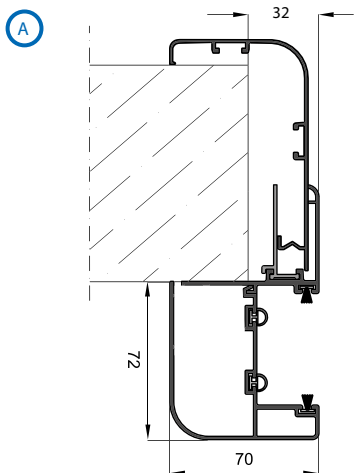
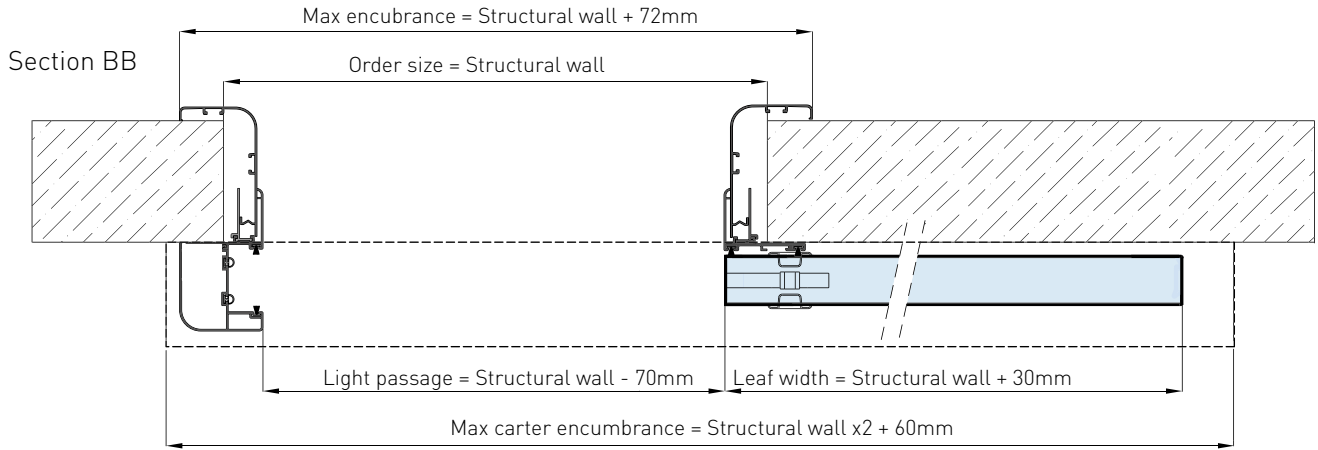
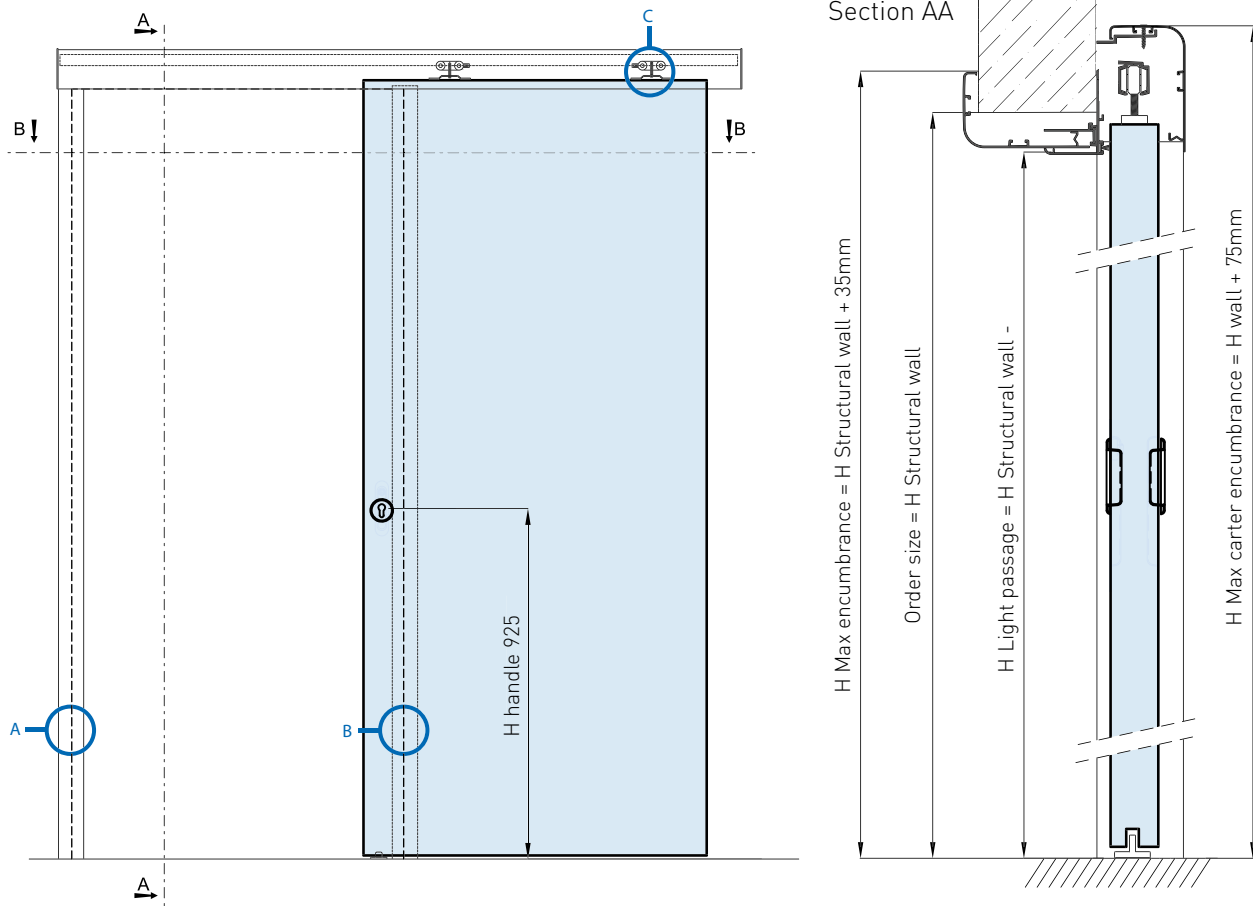

Note: windows and grills are not compatible with this opening system.

KORA Embracing frame sliding leaf outside wall

2 Leaves Door

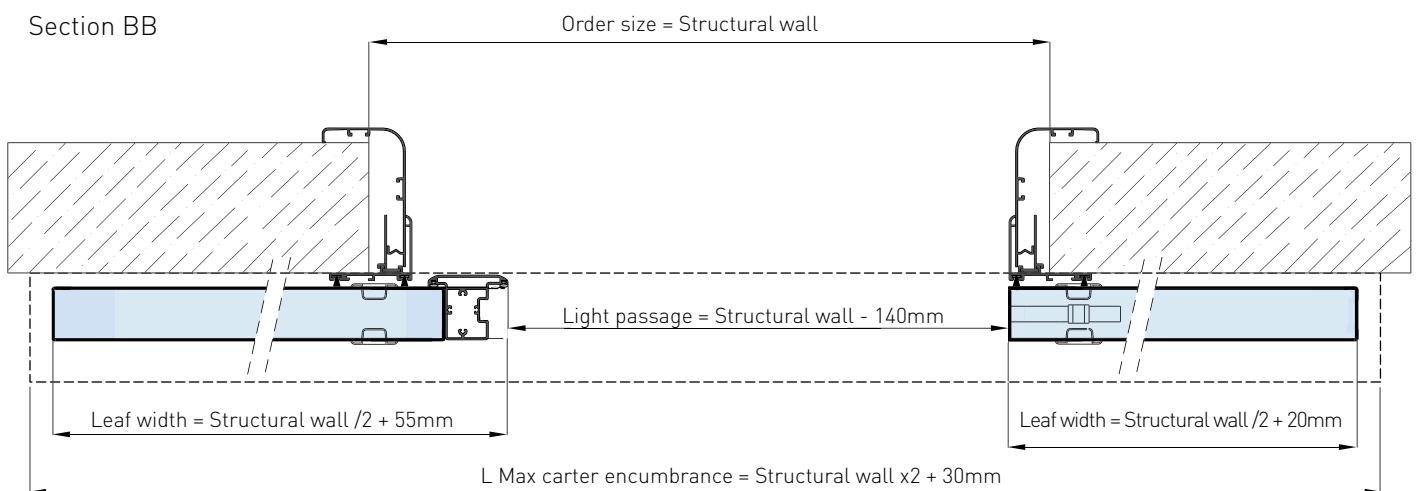
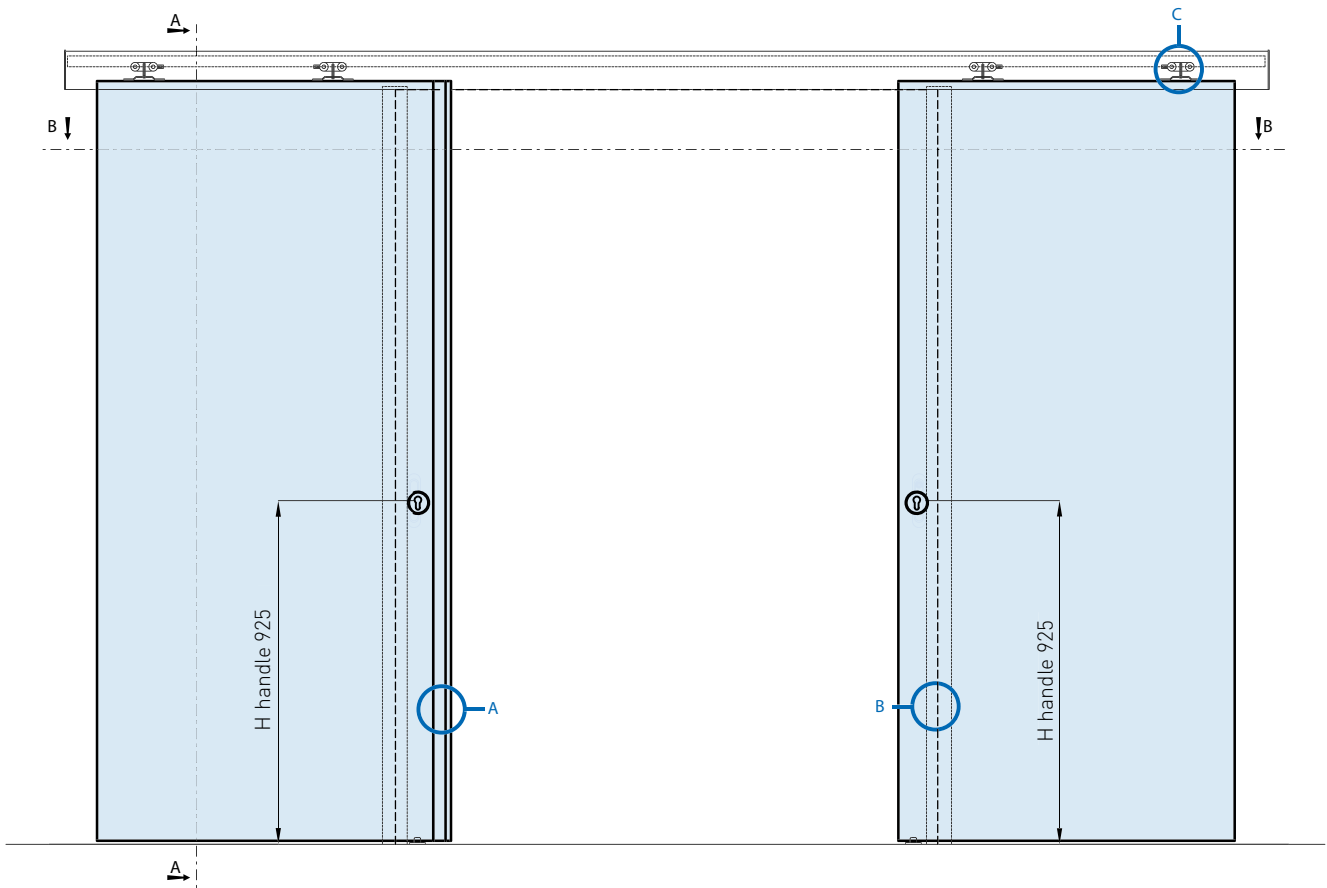

Note: windows and grills are not available.

EMBRACING FRAME SYSTEM FOR SLIDING DOOR KORA OUTSIDE WALL

WALL THICKNESS	TYPE	DESCRIPTION
da 90 a 99 mm	A	Covering profile A
da 100 a 120 mm	B	Covering profile B
da 121 a 150 mm	A + P	Covering profile A + 1 shaft P
da 151 a 180 mm	B + P	Covering profile B + 1 shaft P
da 181 a 210 mm	A + 2P	Covering profile A + 2 shaft P
da 211 a 240 mm	B + 2B	Covering profile B + 2 shaft P
Structural wall thickness (SPM) to be always specified when ordering		

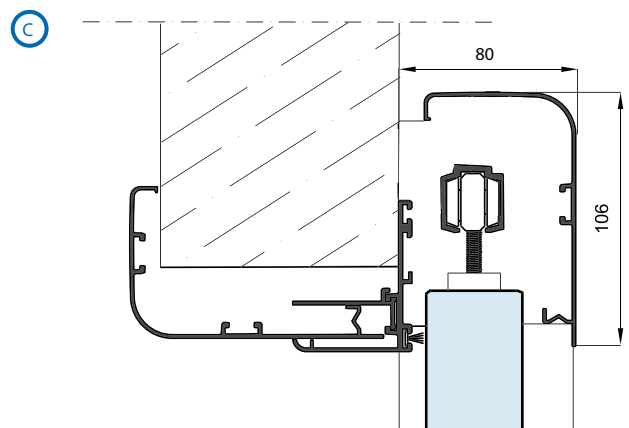
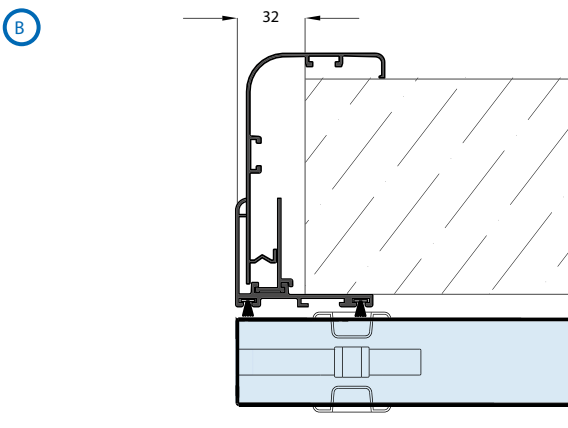
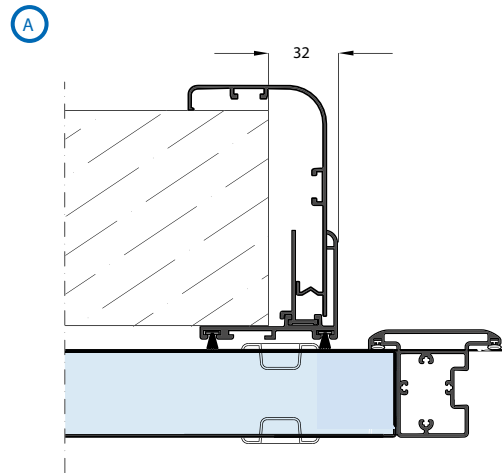
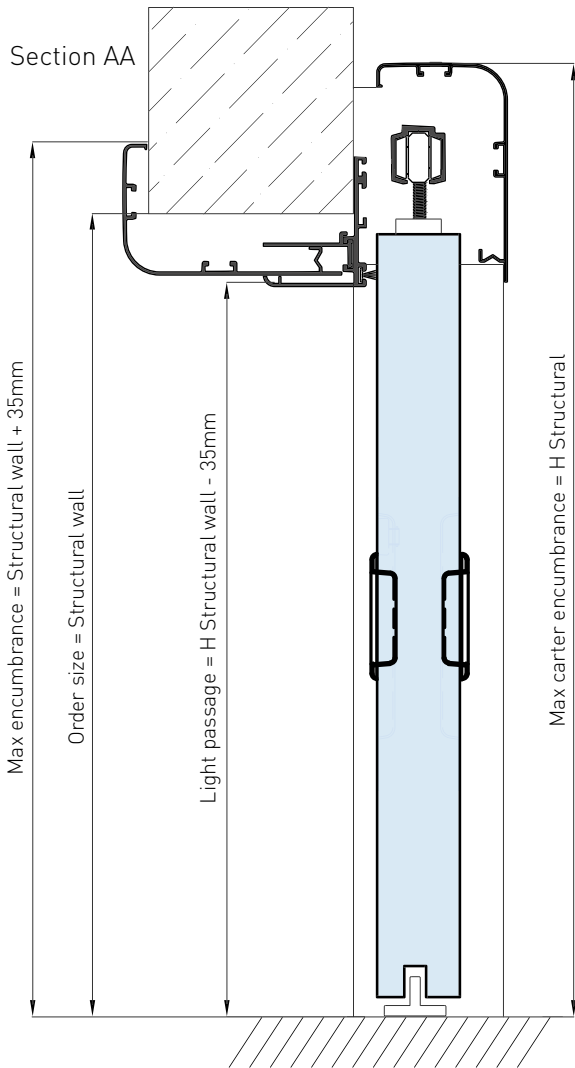

KORA Corner frame sliding leaf outside wall

1 Leaf Door

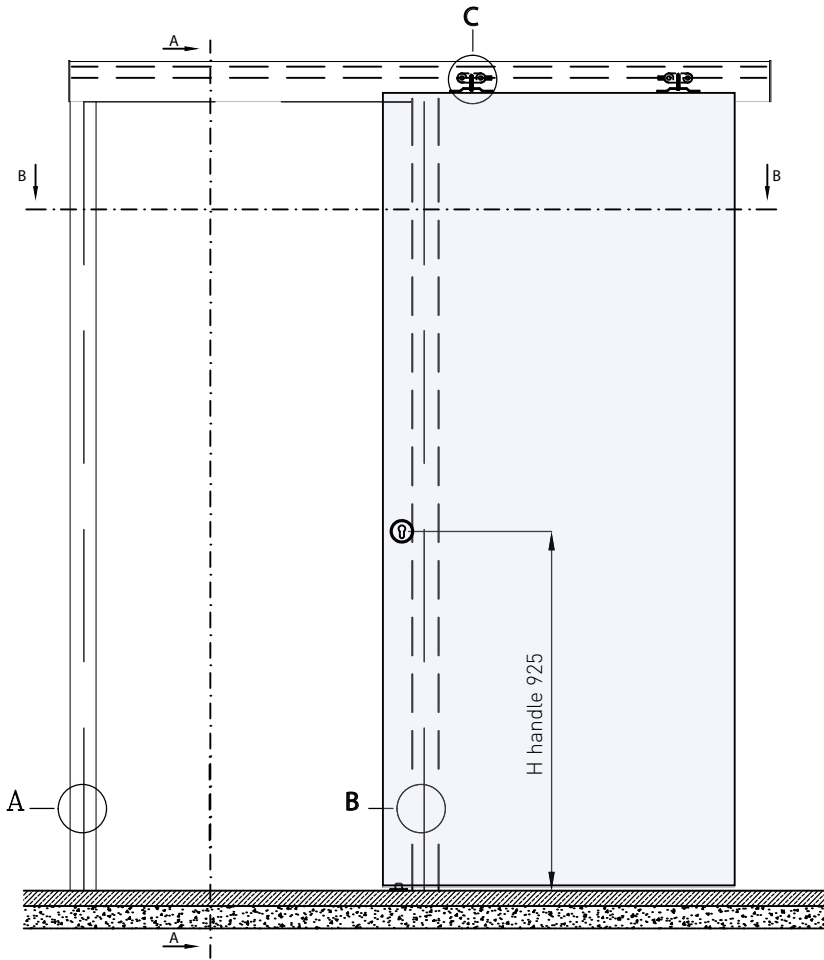

Section AA corner frame

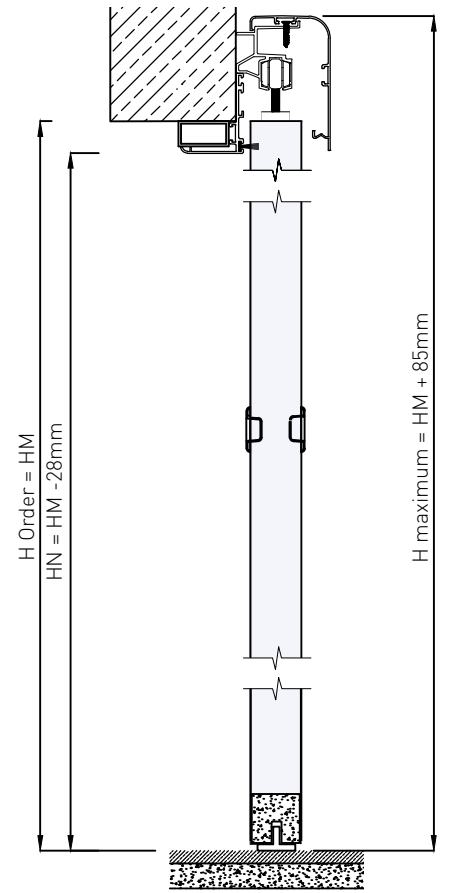

Section BB

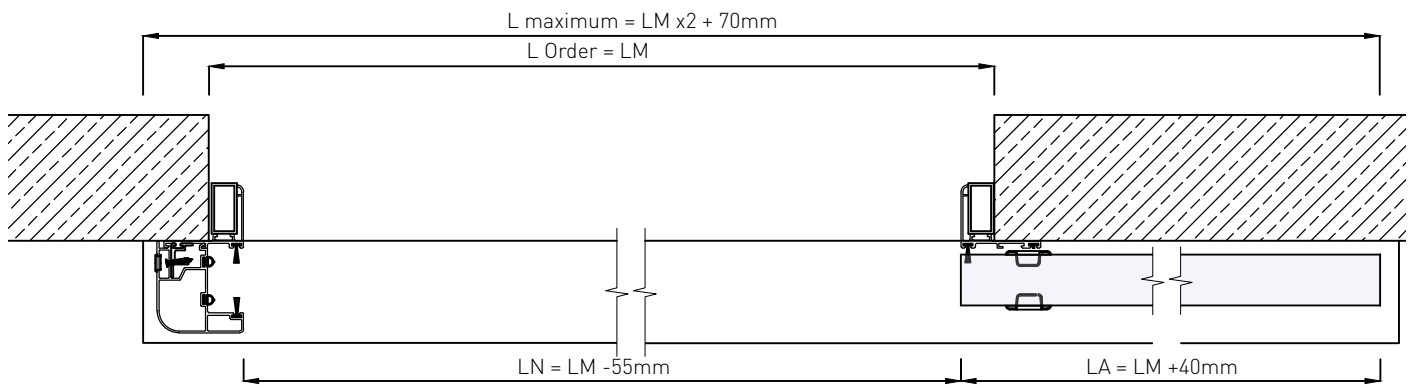

Detail A

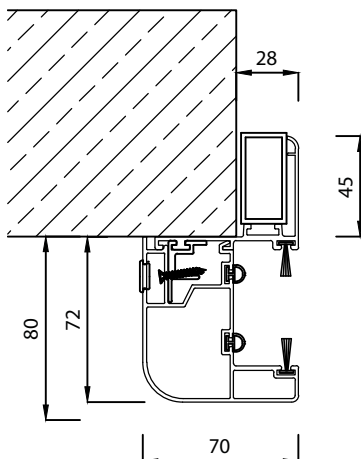

Detail B

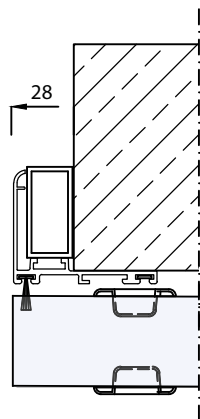

Detail C

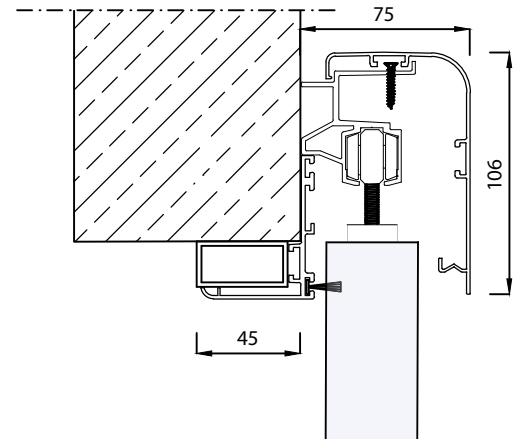

KORA Corner frame sliding leaf outside wall

2 Leaves Door

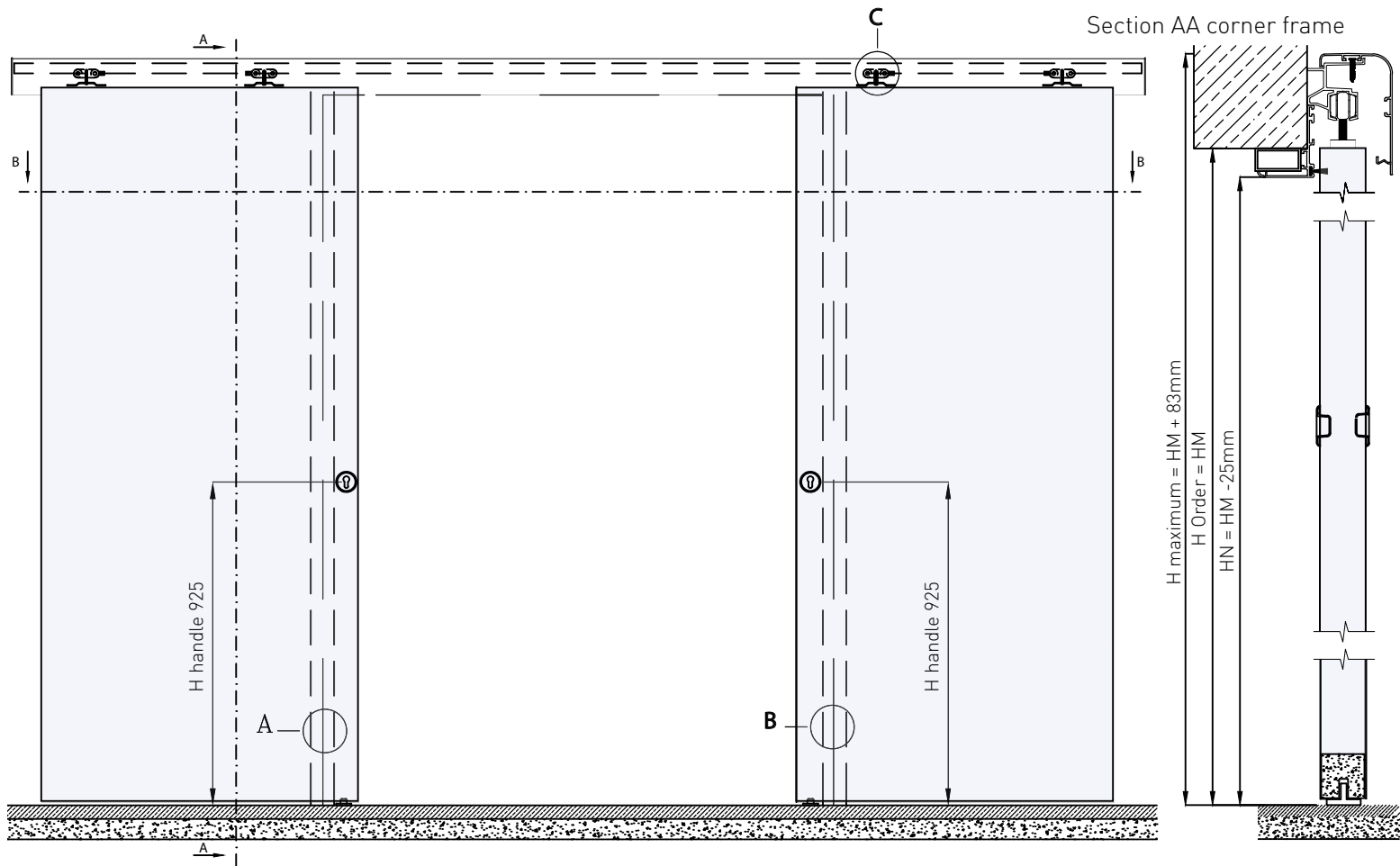

Section BB

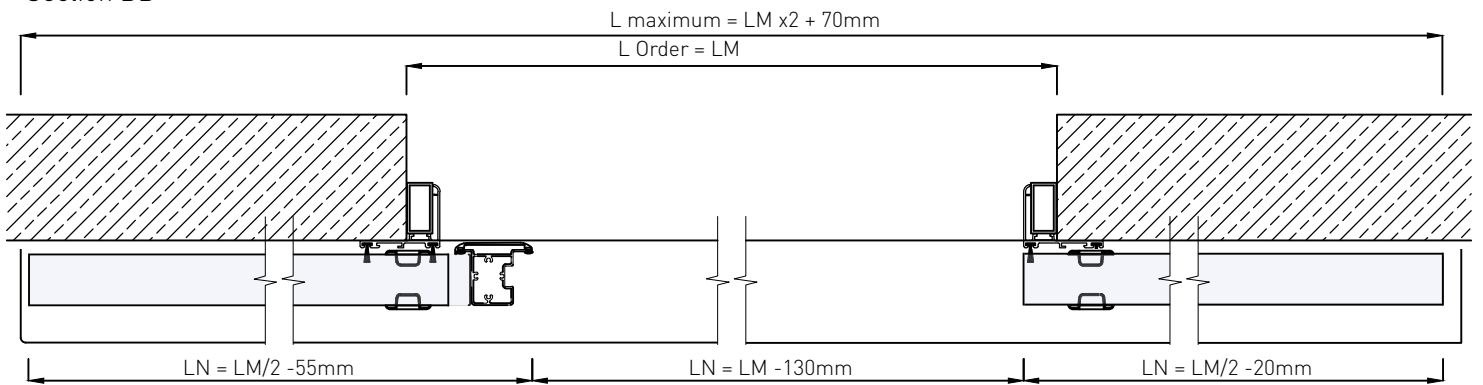

Detail A

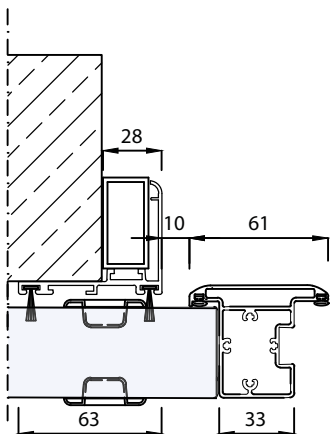

Detail B

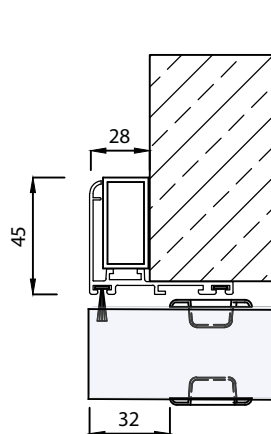

Detail C

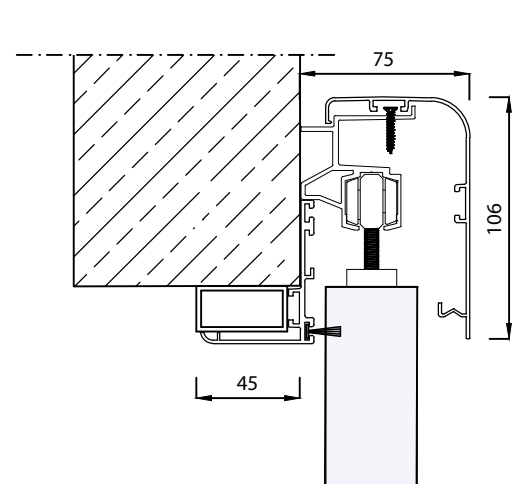

KORA BASIC Corner frame hinged leaf

1 Leaf Door

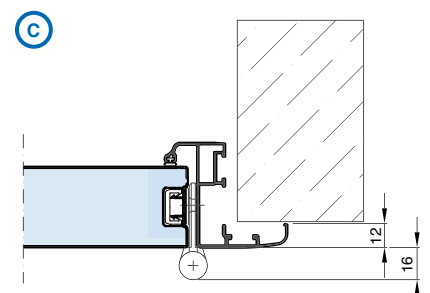
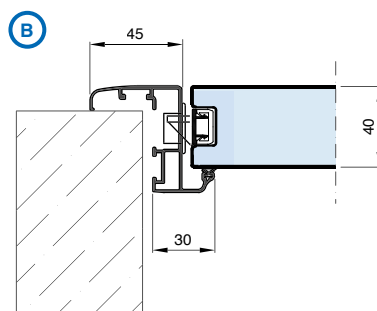
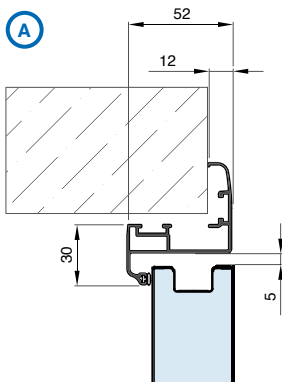
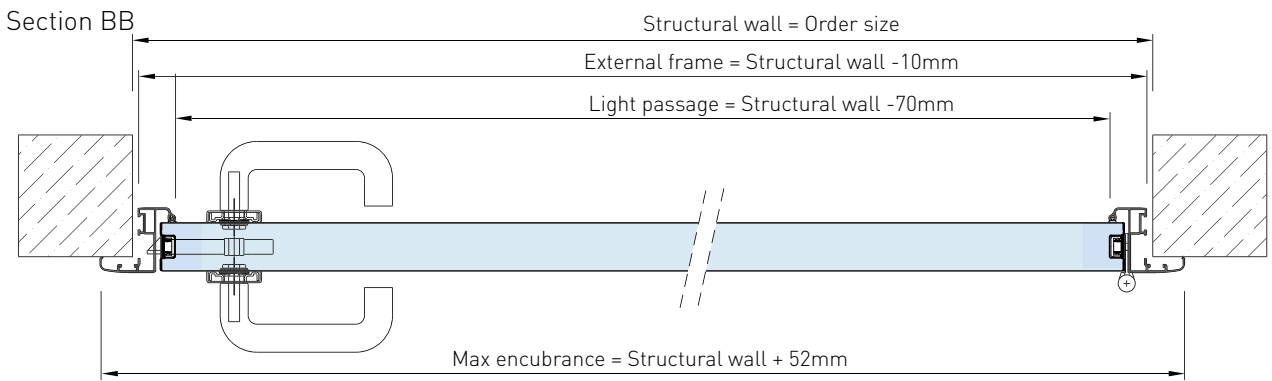
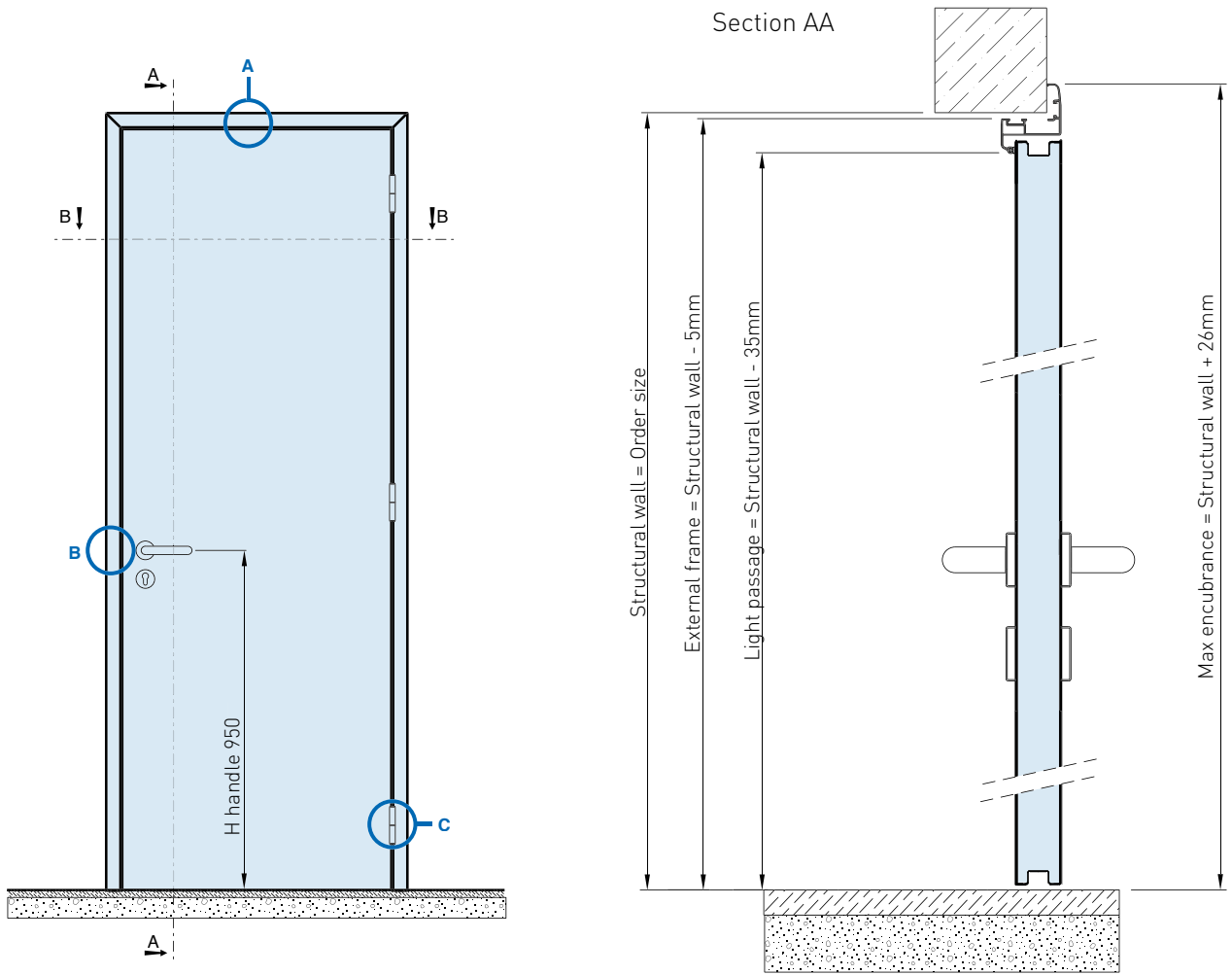

See standard dimension table

KORA FILL Embracing frame hinged leaf

1 Leaf Door

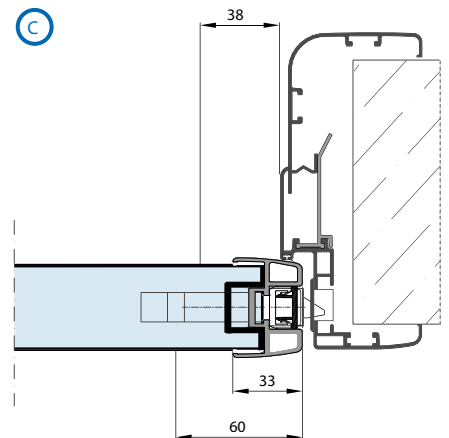
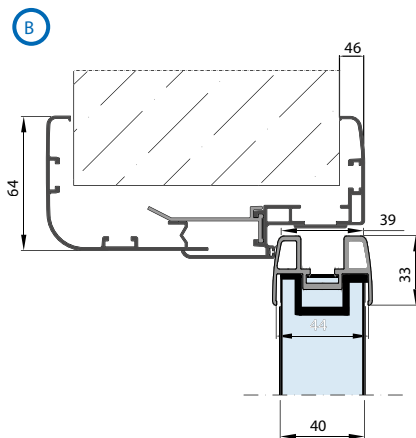
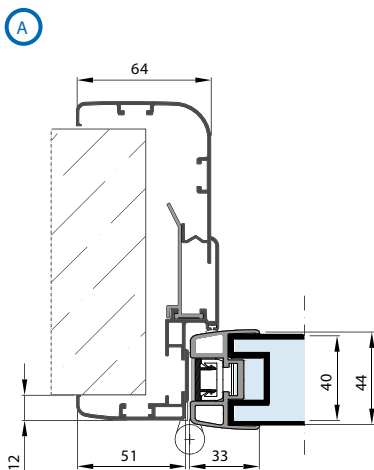
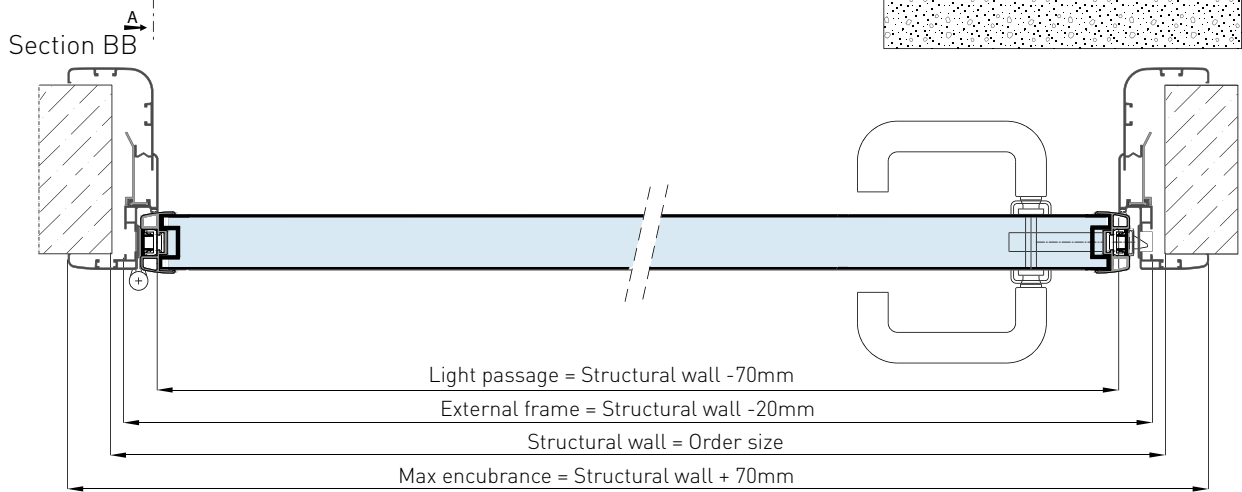
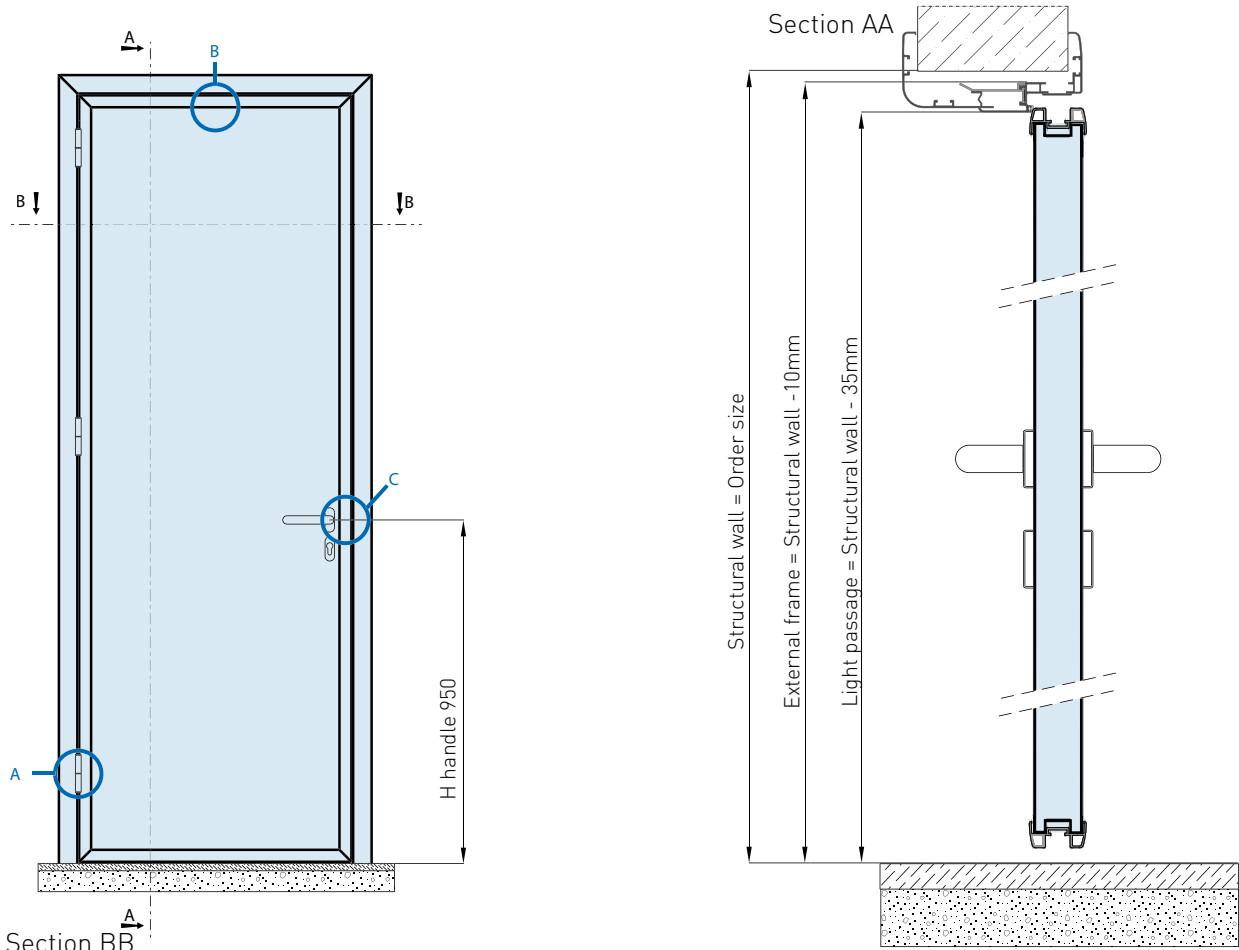

KORA GLASS Embracing frame hinged leaf

2 Leaves Door con sopraleuce

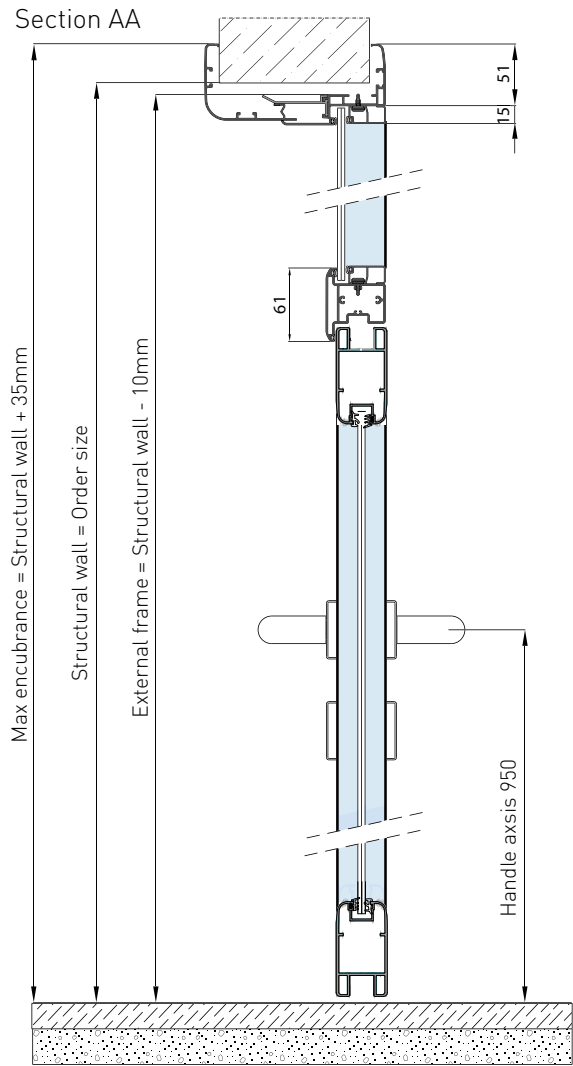
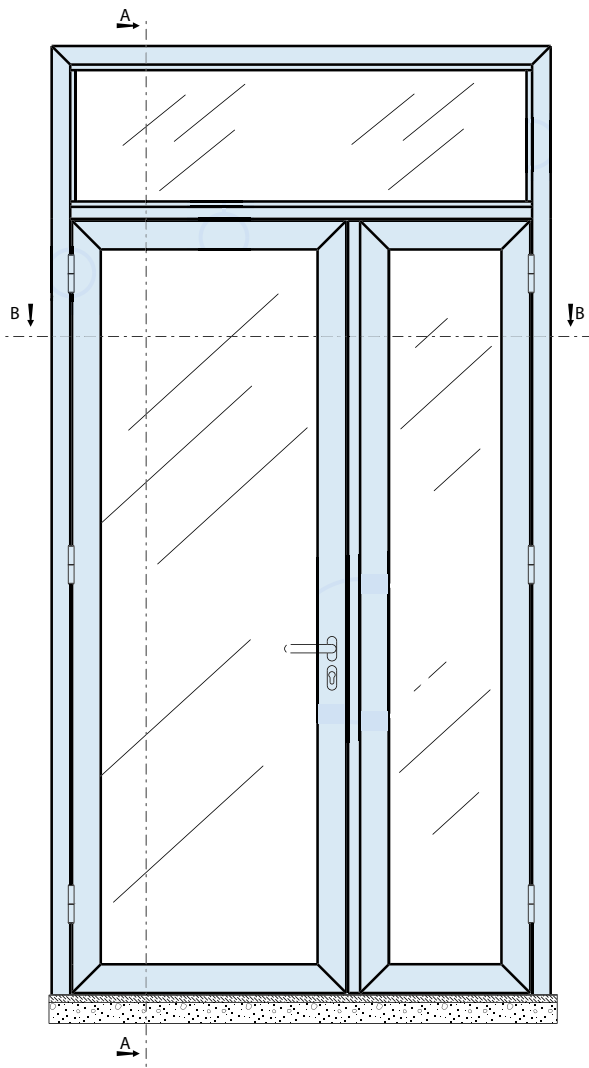

Section BB

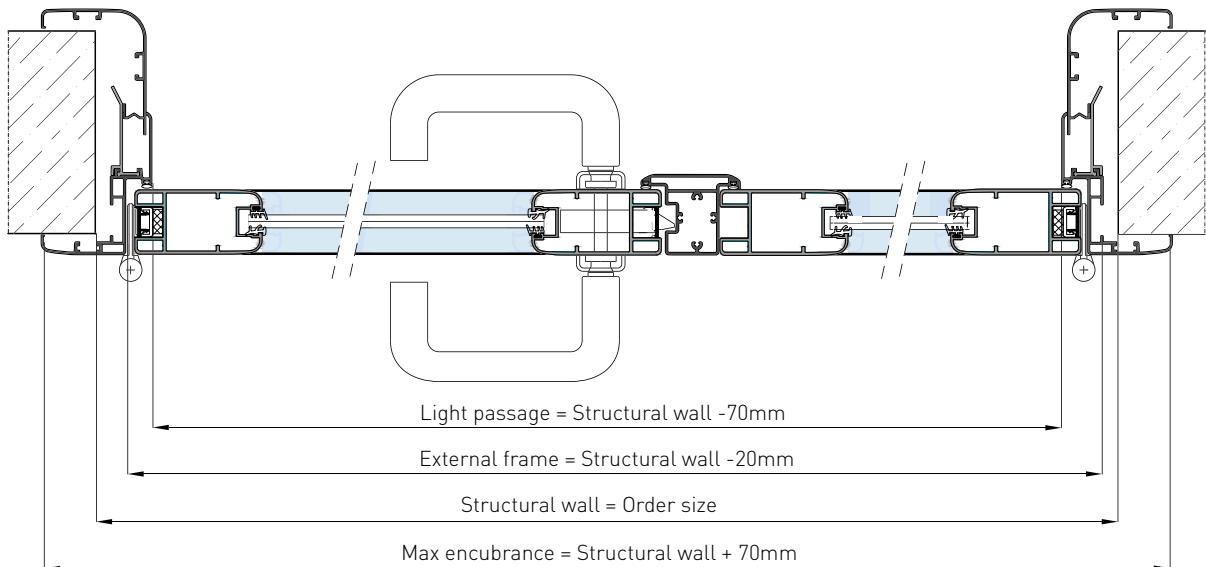

Accessories for KORA

For KORA Hinged

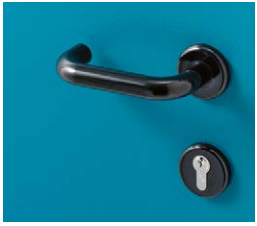

Black handle with rosette (standard)



Anodized aluminum handle with rosette



Black handle with "free/engaged" signal External side



Black handle with "free/engaged" signal External side

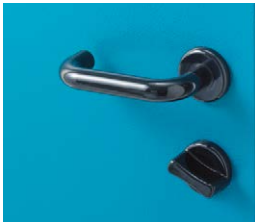

Internal side



Internal side

For KORA glass version only narrow rosette. Also available in the stainless steel version.

For KORA Swing

Kit A circular rosettes free/engaged

internal view

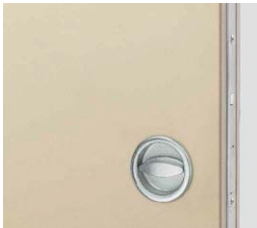

kit M circular rosettes with foldable patent key

internal view



Circular rosettes with handle on both side

internal view

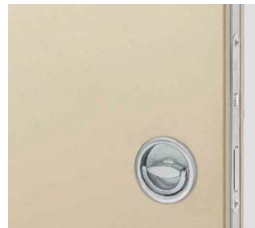

Circular rosettes free/engaged with indicator

internal view



Kit K circular rosettes with cylinder hole

internal view



Kit A circular rosettes free/engaged

external view



kit M circular rosettes with foldable patent key

external view

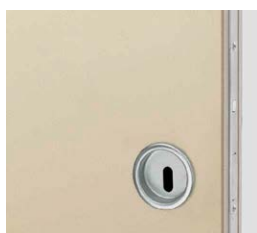

Circular rosettes with handle on both side

external view



Circular rosettes free/engaged with indicator

external view



Kit E blind circular rosettes

external view

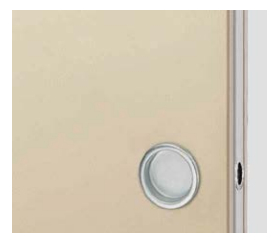

For kora glass sliding version only blind rosette available

Accessories for KORA



Panic device
Novopush black
color or stainless
steel finish



Panic device
with lever
Novoguard
in anodized
aluminum or
stainless steel
finish



PAD for secondary leaf,
available also in black
colour



Ventilation grill
in anodized
aluminum
(different sizes)



Windows
with 3/3 glasses
(different sizes)



Fixed handle
in black color,
stainless steel
finish
or aluminum

Order form

KORA DOORS

FRAME

- Basic
- Lam
- Fill
- Glass

MODEL

- Corner
- embracing

OPENING

- Hinged
- Swing
- Sliding outside wall
- Sliding inside wall

see Attachment 1

TO FILL

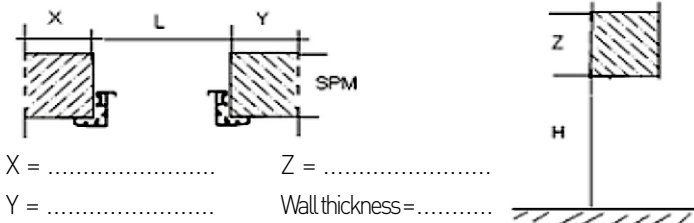

Sign the opening type

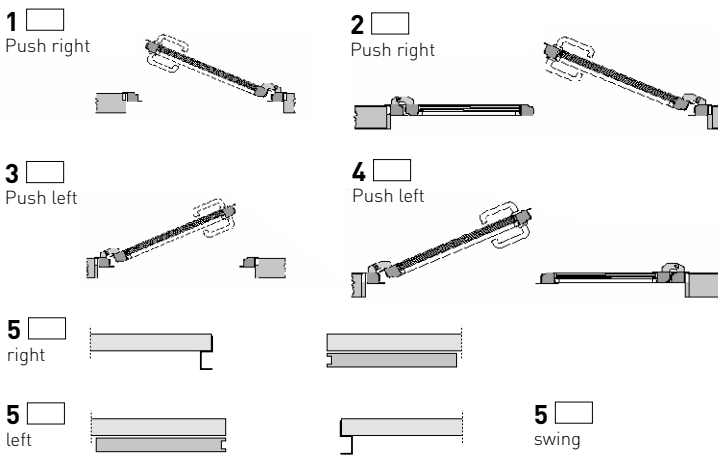

FIXING TYPE

CORNER FRAME

- Concrete wall
- Steel preframe

EMBRACING FRAME

- Concrete wall
- Woodl preframe
- gypsum carton wall

FIXING PARTITION

- Blind top panel H = Door opening size =
- Glass top panel H = Door opening size =
- Side glass panel L = Door opening size =
- Right inside view Left inside view

HANDLE for hinged doors

- Couple of black handles with rosette
- Couple of handles aluminum with rosette.
- Couple of black handles with rosette WC
- Couple of handles aluminum with rosette WC
- Knob
- Art.....
- Free/engaged indicator

HANDLE

- Kit A circular rosettes free/engaged
- kit M circular rosettes with foldable patent key
- Circular rosettes with handle on both side
- Circular rosettes free/engaged with indicator
- Kit K circular rosettes with cylinder hole
- Kit E blind circular rosettes

DATE

CUSTOMER.....

PAGE.

WALL SIZE

- L X H (mm) X
- 1 LEAF 2 LEAF
 - SYMMETRIC 1 LEAF mm
- Quantity of doors:

FINISHING

- Standard (leaf RAL 7035, frame in anodized aluminum)
- Leaf powder painting for inside RAL
- Leaf powder painting for outside RAL
- Frame painting RAL
- Leaf laminate covering Abet

WINDOWS

- on leaf first leaf secondary leaf
- size 300*400 diam. 500
- 150*800 diam. 300
- 250*800
- custom size mm.
- only hole mm.

VENTILATION GRILL

- on leaf first leaf secondary leaf
- top bottom
- size 300*100 400*200
- 400*100
- custom size mm.
- only hole mm.

PANIC DEVICE

- push side Novoguard bar
- Novoguard mechanism color.....
- others.....
- pull side black handle
- aluminum anodized handle
- key
- blind leaf

Order form

KORA DOORS Sliding Inside Wall



Attachment 1

TO FILL

L =
 H =
 Z =
 Z1 =
 Z2 =
 Z3 =
 Z4* =

*compulsory measures

Finished wall thickness =
 Internal space minimum 65mm
 (with grill and rectangular window - with circular window min 70mm)

Frame brand/model

.....

DATE

CUSTOMER.....

PAGE.

HANDLE

- Kit A circular rosettes free/engaged
- kit M circular rosettes with foldable patent key
- Circular rosettes with handle on both side
- Circular rosettes free/engaged with indicator
- Kit K circular rosettes with cylinder hole
- Kit E blind circular rosettes

SIZES

HORIZONTAL SECTION

1 leaf

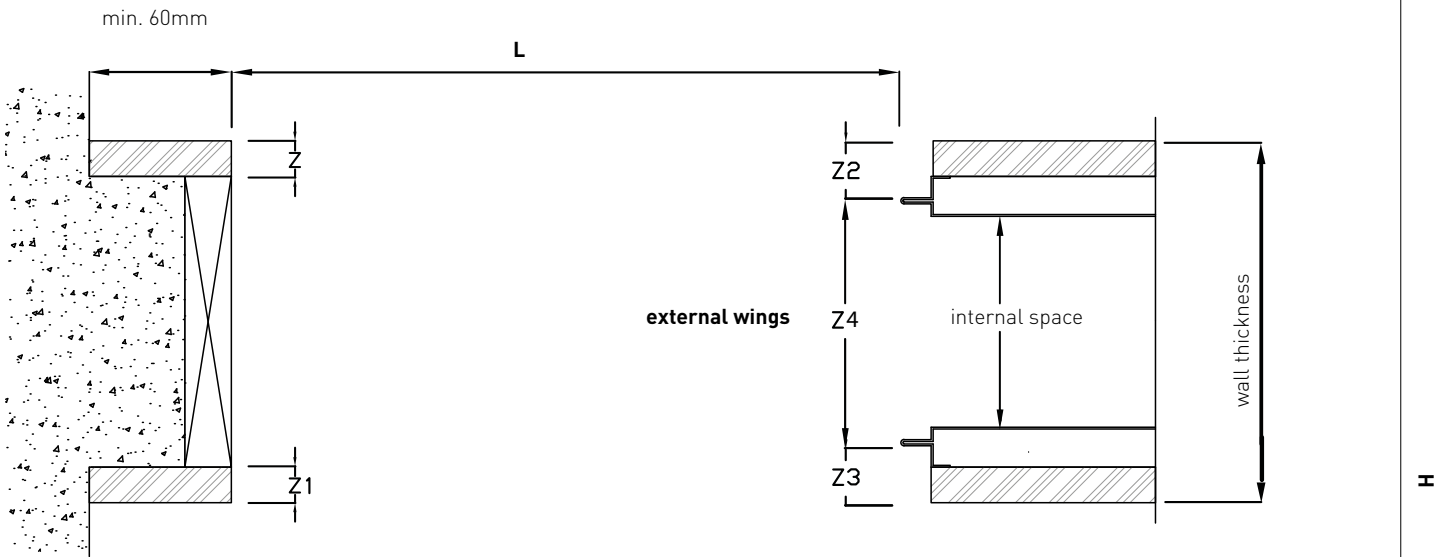

2 leaf

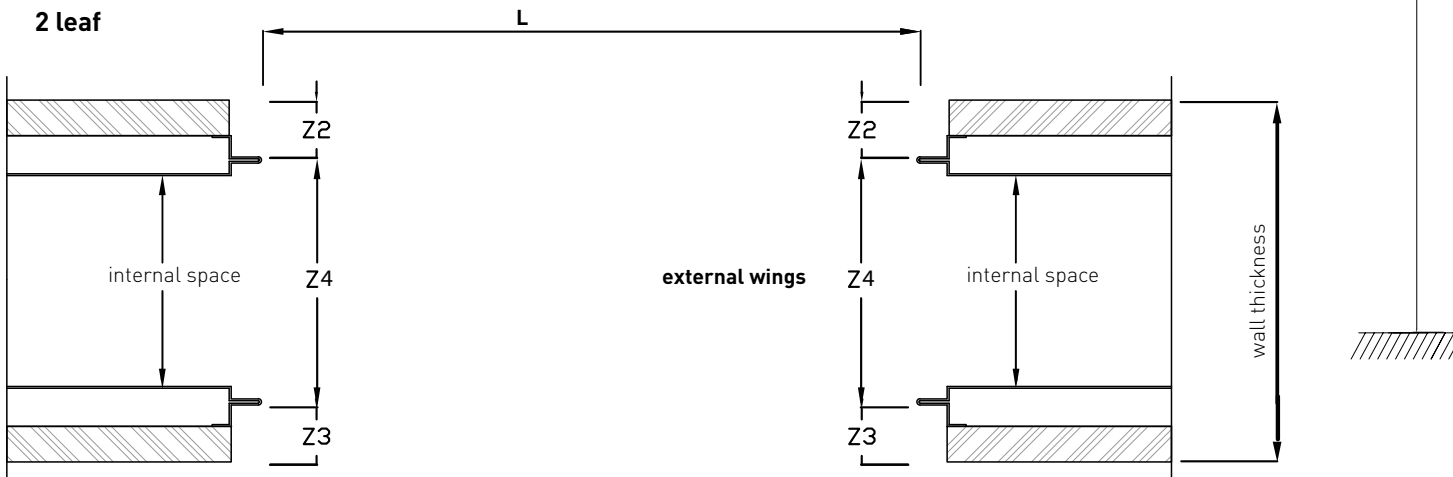

Novoferm Dealer:

NOVOFERM SCHIEVANO s.r.l.
35012 Camposampiero
Padova (Italy)
Via A. Volta, 1

Tel. +39 049 9315111
Fax +39 049 9301877

ufficio.commerciale@novoferm.it
www.novoferm.it

